



Supplementary Information

Written submission from Best Theratronics Limited

In the Matter of the

Best Theratronics Limited

Application for the renewal of the Class IB
Nuclear Substance Processing Facility
Operating Licence

Commission Public Hearing

May 16, 2019

Renseignements supplémentaires

Mémoire de Best Theratronics Limited

À l'égard de

Best Theratronics Limited

Demande de renouvellement du permis
d'exploitation d'une installation de traitement
de substances nucléaires de catégorie IB

Audience publique de la Commission

Le 16 mai 2019

*This page was intentionally
left blank*

*Cette page a été intentionnellement
laissée en blanc*

Best[®] *Theratronics*

**Class 1B License Renewal
Class II Facility & NSRD License Applications
CMD 19-H2.1C**

The Future of Healthcare Delivery in the 21st Century – Contributions of TeamBest Companies & Best Cure Foundation



Best[™] medical international

TeamBest[®] Theratronics ASIA

Best[™] Cyclotron Systems

Best[™] Particle Therapy

Best[™] Theratronics

Best[™] medical canada

Best[™] medical italy

Best[™] ABT Molecular Imaging

Best[™] vascular



Best Cure
FOUNDATION



Best[™] entertainment
for everyone

 **KITSAULT**
ENERGY
FUELING THE FUTURE



arplay medical

HUESTISMEDICAL
making it affordable[™]

Best[™] nomos[®]

Best[™] Dosimetry Services

CNMC+ *Best*[™] NDT
A TeamBest Company

Your Total Solutions[™] Provider!



Best
Cure
FOUNDATION

About Krishnan Suthanthiran

President TeamBest Companies & Founder of Best Cure Foundation

*A healthy person
has many wishes,
but the sick person
has only one.
Health is wealth.*

– Indian Proverb –

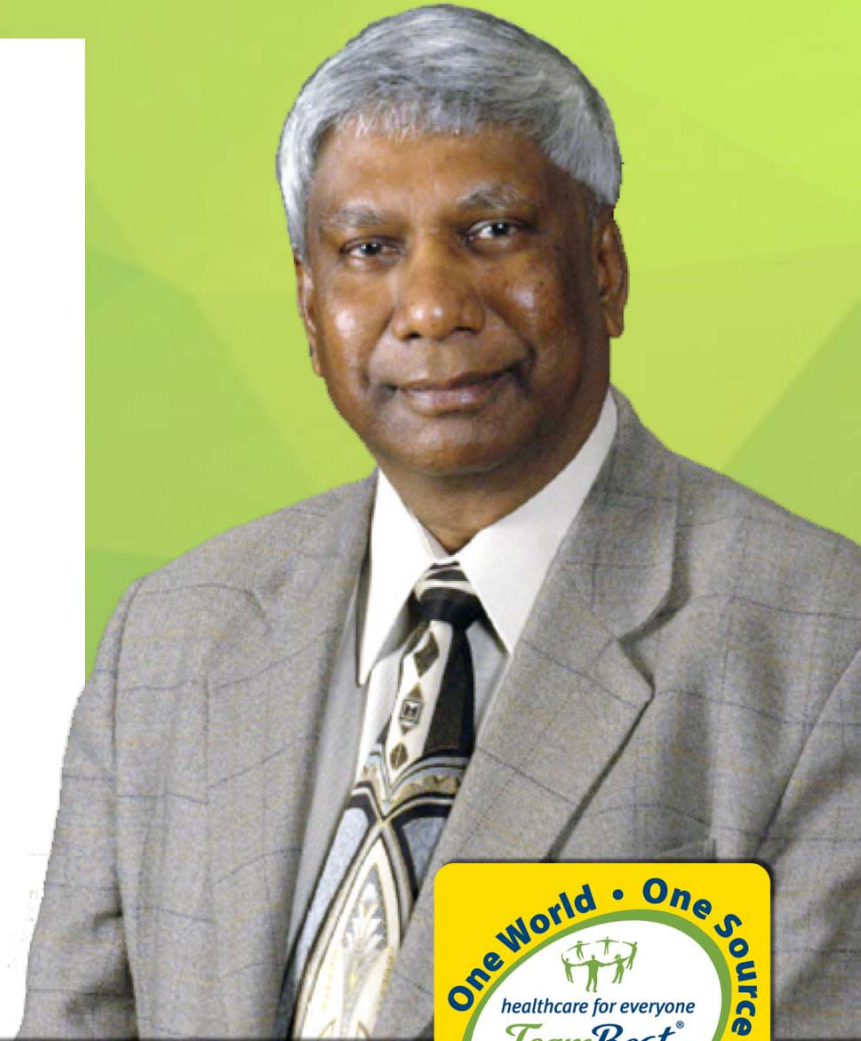

Best Cure
FOUNDATION

www.bestcure.md www.teambest.com



About Krishnan Suthanthiran

President TeamBest Companies & Founder of Best Cure Foundation

Life is a gift from our parents. We are born to live, and live to enjoy and cherish our gift. We can look at every obstacle as an opportunity or every opportunity as an obstacle. Who we are, what we are, and where we are, have a lot to do with the choices we have made and the ones we did not.

Our career and service to the community are the outcome of what we do with the gift.

— Krishnan Suthanthiran —

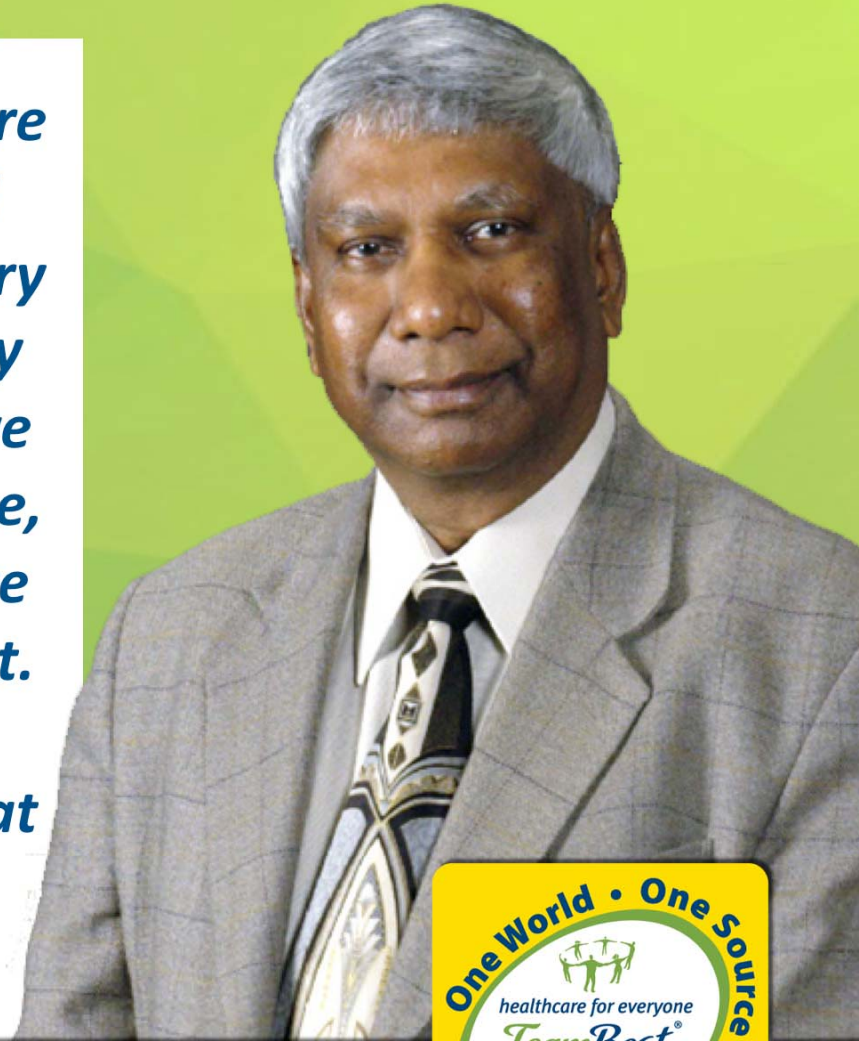

Best Cure
FOUNDATION

www.bestcure.md www.teambest.com



ABOUT KRISHNAN SUTHANTHIRAN

Krishnan Suthanthiran immigrated to Canada from India in September 1969 after graduating with a Bachelor's Degree in Mechanical Engineering from University of Madras, India, to pursue his Master's Degree in Mechanical Engineering at Carleton University, Ottawa, Ontario, Canada. He arrived with a total of 400 Canadian Dollars. Subsequently, he received a National Research Council of Canada Research Assistantship, and graduated with a Master's Degree in 1971. He moved to the United States in 1972 and worked as an Engineer Physicist at Howard University Hospital in Washington, DC, USA until 1978.

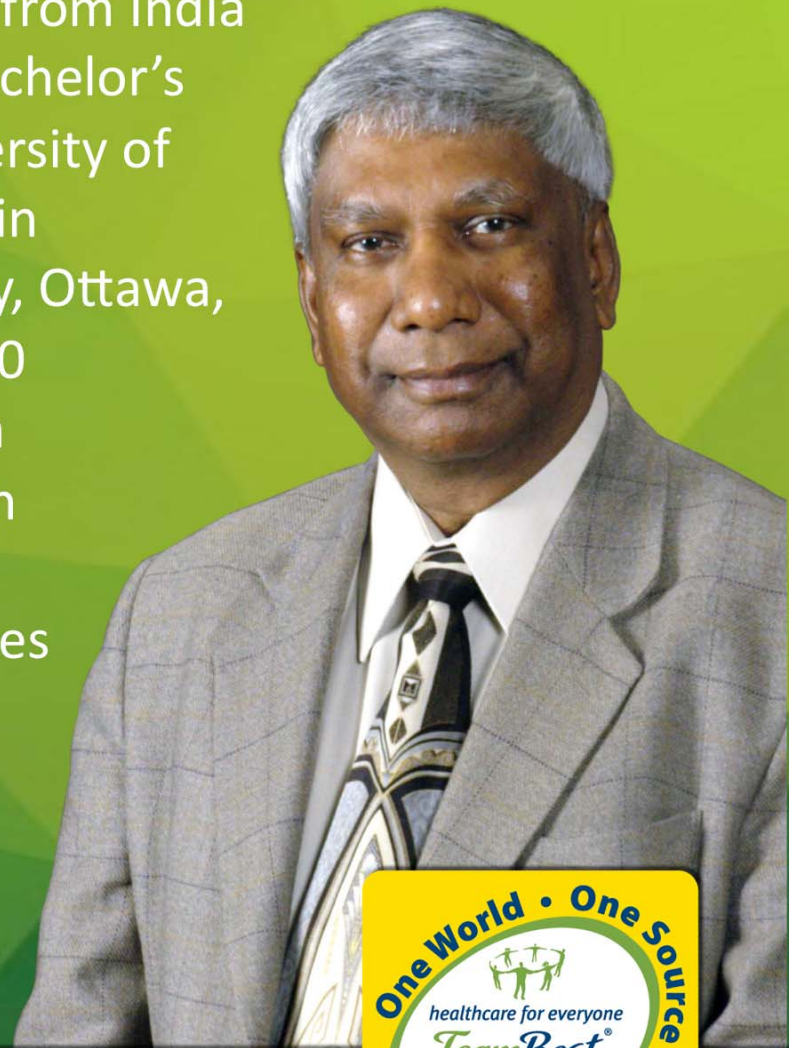

Best Cure
FOUNDATION

www.bestcure.md www.teambest.com



ABOUT KRISHNAN SUTHANTHIRAN (cont.)

Having lost his father to cancer while he was an undergraduate student in engineering, he has dedicated his career to cancer prevention, early detection and effective treatment for the Total Cure. He has founded and invested globally many millions of USD in medical, real estate, construction, entertainment, and energy companies. He founded and currently is supporting a few non-profit charitable foundations to promote quality education and healthcare and making them affordable and accessible. He has contributed substantially to setting up endowed chair and endowments for scholarships. Also, he has provided significant funding to support medical research and treatment by partnering with academic centers, national labs, and hospitals globally.

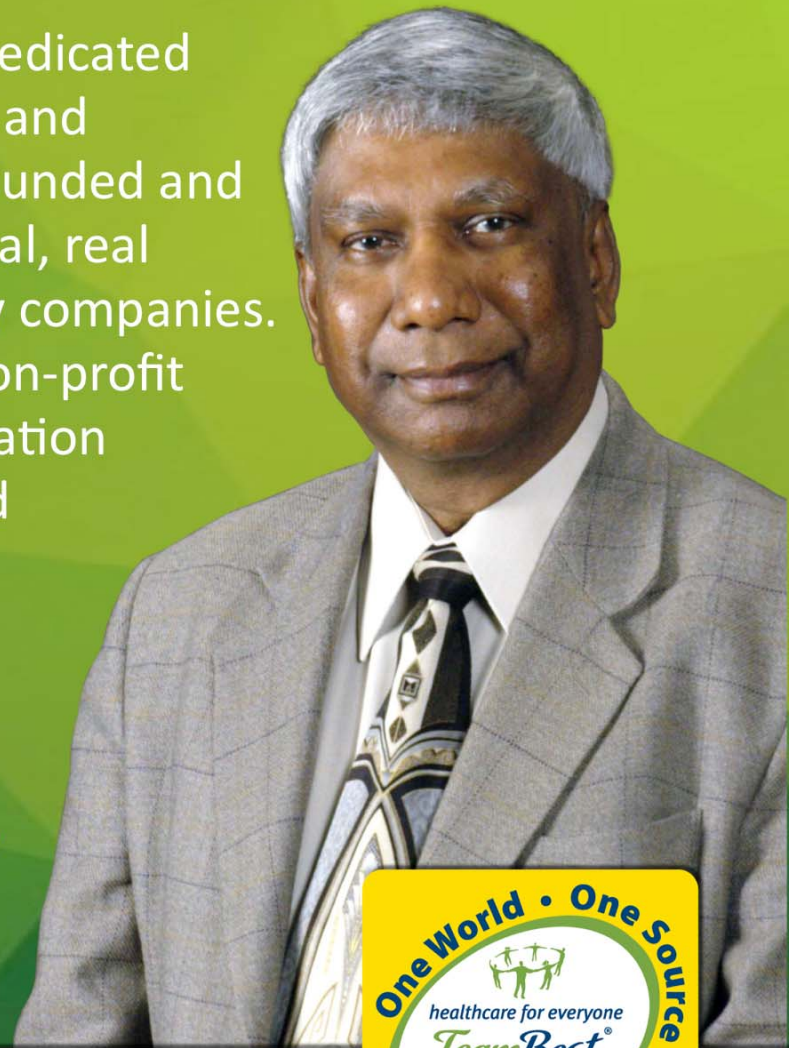

Best Cure
FOUNDATION

www.bestcure.md www.teambest.com



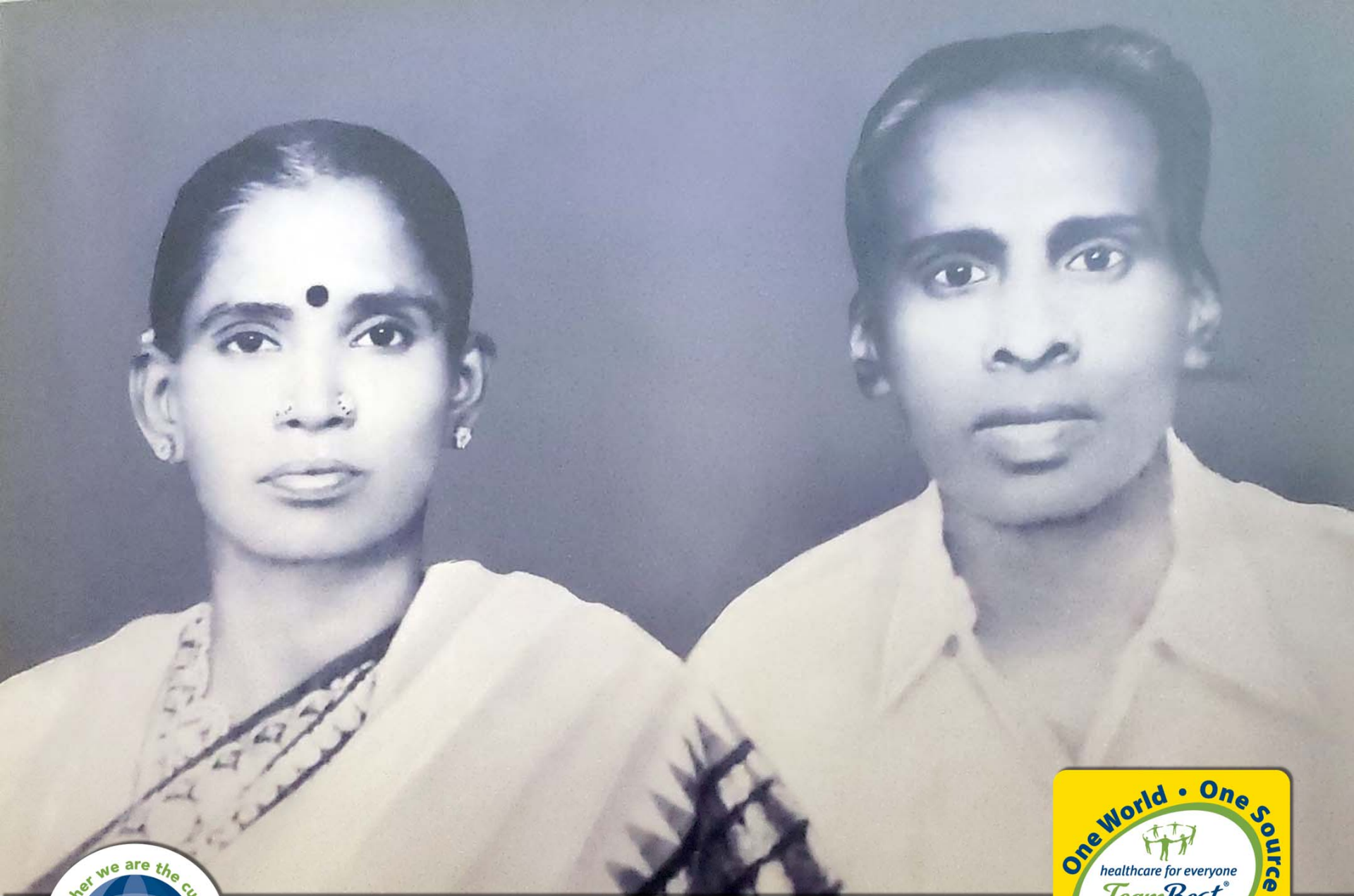

Best Cure
FOUNDATION

www.bestcure.md www.teambest.com





Krishnan Suthanthiran has established a division under BCF called “3E – Education, Empowerment and Equality” to promote the development and advancement of women. It is his belief that every man and woman was given birth to, nursed, and nourished by women, and therefore, they share a greater responsibility in juggling career and family, in raising children and caring for the home. In memory of his mother, Krish is proud to support women around the world in pursuing their goals through the 3E organization.



Best Cure
FOUNDATION

www.bestcure.md www.teambest.com



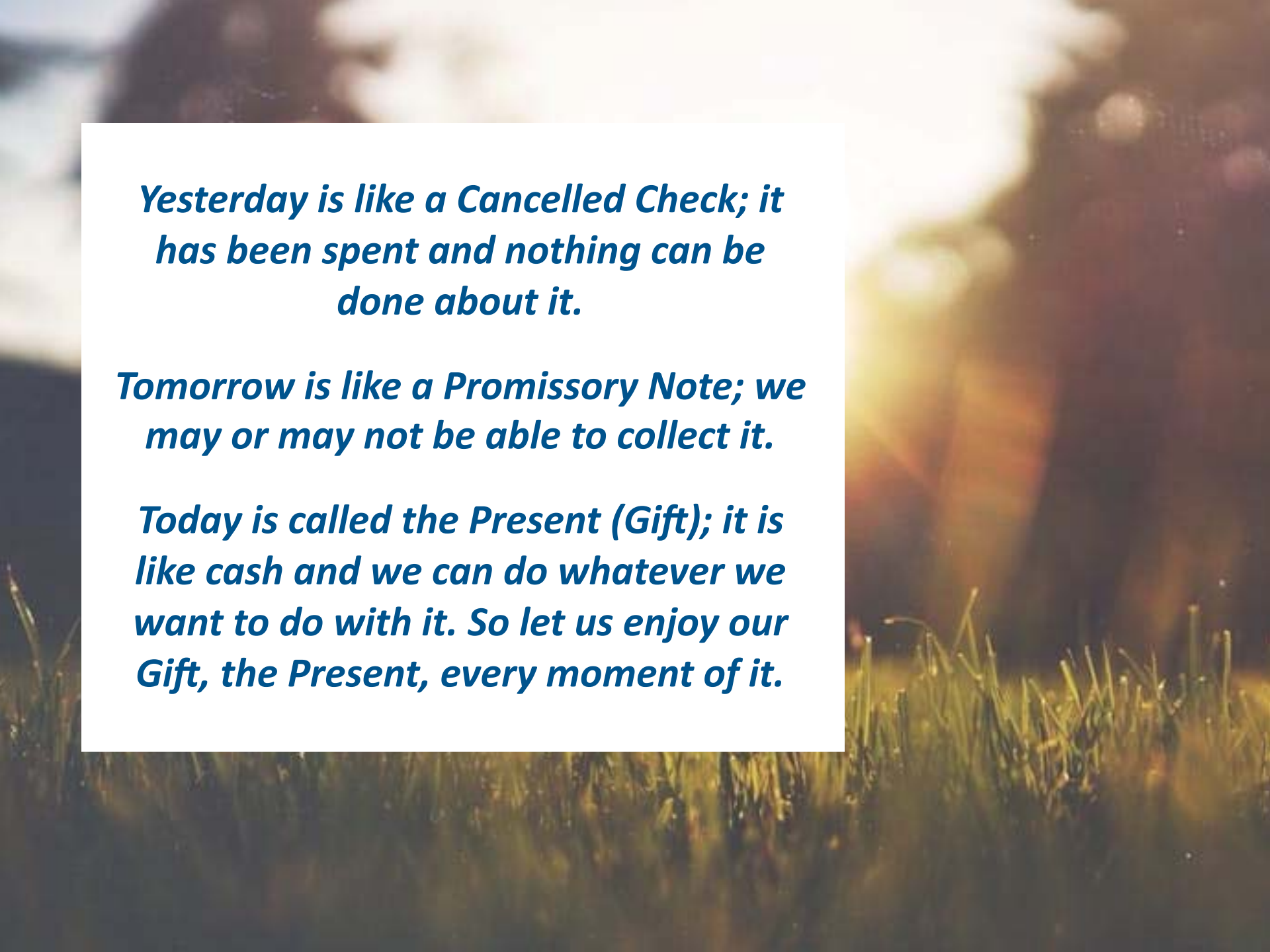

Yesterday is like a Cancelled Check; it has been spent and nothing can be done about it.

Tomorrow is like a Promissory Note; we may or may not be able to collect it.

Today is called the Present (Gift); it is like cash and we can do whatever we want to do with it. So let us enjoy our Gift, the Present, every moment of it.

Best Cure Foundation's aim is to:

- Reduce the cost of healthcare worldwide by 30 percent or more
- Launch the Best Cure Total Health™ Program
- Increase transparency through Best Cure Proactive Healthcare™



Best Cure
FOUNDATION

www.bestcure.md www.teambest.com



Best Cure Foundation's aim is to:

- Establish:
 - Express/mobile clinics and medical centers as non-profit, private, non-governmental organizations that are self sustaining
 - Best Cure U.S. Health Corps
 - Best Cure International Health Corps
 - Best Cure Global Institute
 - Best Cure Global Standard of Care
 - Best Cure Global Purchasing Organization
 - Best Cure Global Insurance



Best Cure
FOUNDATION

www.bestcure.md www.teambest.com



BEST CURE FOUNDATION's GOALS



Best Cure
FOUNDATION

www.bestcure.md www.teambest.com



A photograph of two young children playing in a water fountain. The child in the foreground, wearing a blue shirt, is reaching out with their hands to catch a stream of water falling from the fountain. The child in the background, wearing a yellow shirt, is also smiling and looking towards the water. The background is a blurred green field, suggesting an outdoor setting. The overall scene is bright and cheerful, emphasizing the importance of clean water.

GOAL 1

Providing **purified drinking water** and affordable sewer systems in every part of the world by 2030

GOAL 2

Establishing a global standard of **healthcare** delivery system using a hub & spoke model with express and mobile clinics linked to general and super specialty medical centers





GOAL 3

Reduce suffering/deaths from major diseases such as cardiac, cancer, diabetes, etc. by 50% by the end of the next decade



3E – Education, Empowerment and Equality

Promoting the development
and advancement of women.

Global War on Cancer

Launched by Best Cure Foundation & TeamBest Companies

While there have been many significant improvements and advancements in medical technologies, many patients around the world do not receive timely interventions or the right care. Mr. Suthanthiran firmly believes more should be done. In 2007, he formed the Best Cure Foundation to work with TeamBest companies, and other leading-edge companies and experts, to establish a Hub-and-Spoke model of healthcare delivery systems to overcome these shortcomings. Best Cure Foundation's goal is to launch a “**Global War on Cancer**” that includes express and mobile clinics linked to general and super-specialty medical centers worldwide.



www.bestcure.md www.teambest.com



Global War on Cancer

Launched by Best Cure Foundation and TeamBest Companies

Mr. Suthanthiran has interacted with those in the private sector and government agencies, in more than 20 countries over the last few years in Asia, South America, the Middle East, and North America. In that time, he has stated, “It is clear that there is a groundswell of support for a better, affordable, and accessible healthcare delivery system globally.”

He has established and acquired a number of medical companies globally, in order to collect many of the technologies needed to establish a Proactive Healthcare Delivery System, focused on transparency of clinical benefits, outcome, and cost using a Total Health Approach – Prevention, Early Detection, and Effective Treatment for Total Cure.



www.bestcure.md www.teambest.com



Public/Private Partnership Funding Model

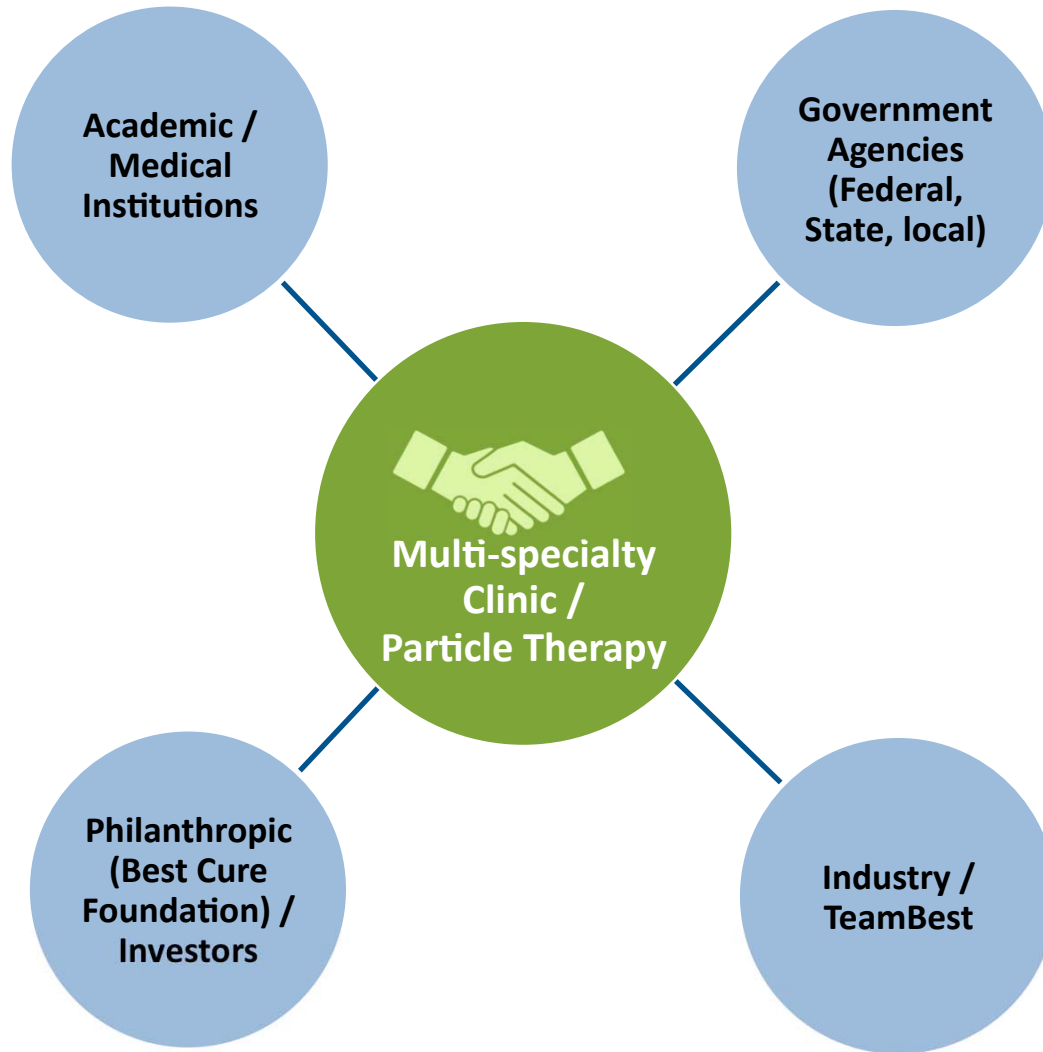

Best Cure
FOUNDATION

www.bestcure.md www.teambest.com



Brownsville Hospital



Best Cure **Health System**

Brownsville, PA

Vision for the future:

- Blood Laboratory
- Imaging Center
- Radiation Oncology
- Medical "Isotope" Production
- Education & Rehabilitation Services
- Proton Therapy Center
- Healing Garden

Emergency Area and Operating Room

Brownsville Hospital



Physicians Scrub Room and ICU

Brownsville Hospital



Lobby and Lab

Brownsville Hospital



Best Theratronics

External Beam Therapy & Accessories





healthcare for everyone

TeamBest[®]

Your True Partner

*GammaBeam*TM

saving lives

Evolution of Radiation Therapy – Cobalt-60

Cobalt 60 widely used for conventional RT in most of the world.

But..

Has lacked the required technical R & D to facilitate IMRT/IGRT...

UNTIL NOW



GammaBeam™ 300 Equinox™ External Beam Therapy System



The GammaBeam 300 Equinox's advanced design provides freedom in treatment planning and can interface to all of the major record and verify systems to allow for rapid treatment parameter loading, treatment set up verification, and the recording of the delivery.

GammaBeam™
saving lives



GammaBeam™ 100-80

External Beam Therapy System



The GammaBeam™ 100-80 is a highly practical model of the GammaBeam family of External Beam Therapy System (EBTS). Convenience and safety, combined with simplicity of design, make it easy to use and easy to maintain.



Motorized and Manual Multi-Leaf Collimators

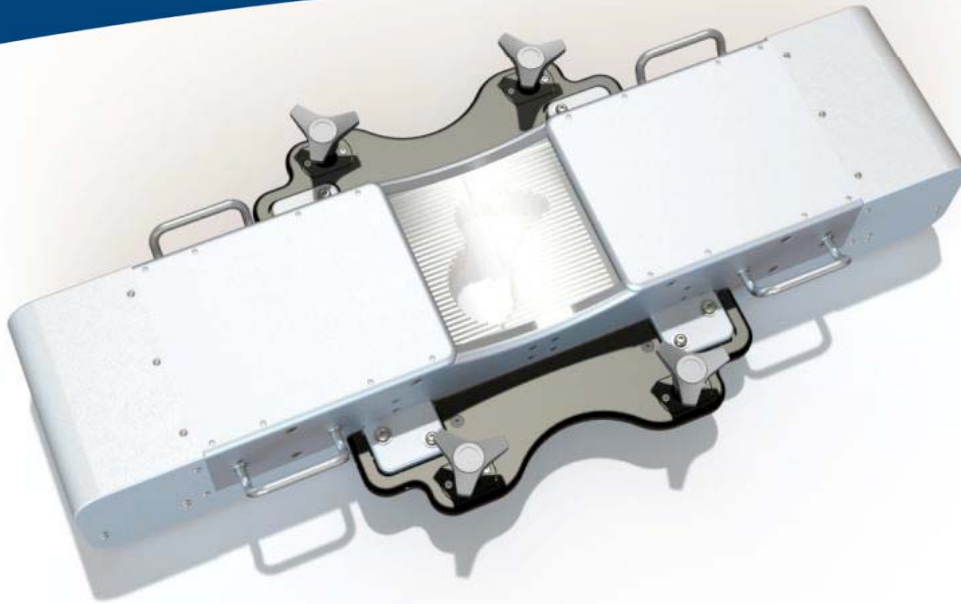

Multi-Leaf Collimators now available as an optional accessory for the Equinox and GammaBeam 100-80 product line, providing 3D Conformal Radiation Therapy (3D CRT) and Intensity Modulated Radiation Therapy (IMRT) capability.



GammaBeam™ 500 Total Body Irradiator



The Total Body Irradiator
GammaBeam 500 is a
teletherapy unit designed to
produce a large fixed rectangular
radiation field at an extended
source-to-skin distance in order
to deliver total body irradiation.
Used in preparation of bone
marrow transplantation.



nomosSTAT™ Serial Tomotherapy



nomosSTAT™ serial tomotherapy delivery technology fires pencil beams from a continuous 340 degree arc around the patient, creating a highly conformal dose distribution.



GammaBeam™ 200 Research Irradiator



The GammaBeam 200 (GB200) is among the most versatile research irradiators available today. Suited to a broad spectrum of applications including secondary standards dosimetry, sterile insect programs, and medical or veterinary research, the unit provides your lab with a powerful tool.



Blood Irradiation - Raycell[®] Mk2



Treatment of Graft-Versus-Host Disease (TA-GVHD) is almost always ineffective, and therefore management must focus on prevention by minimizing the risk of developing the condition. Blood irradiation using the **Raycell[®] Mk2** uses two opposing x-ray tubes to deliver superior uniform dose.



Blood Irradiation – GammaCell® 1000/3000



Blood irradiation using Caesium¹³⁷ available with the **Gammacell® 1000/3000** for superior performance and unparalleled dose uniformity





Best Theratronics Ltd Machine Shop, Ottawa, Canada



Best Theratronics Ltd Assembly Hall

Best ABT Molecular Imaging

Dose On Demand™

BG-75 Biomarker Generator



Best ABT Press Release • November 12, 2018

TeamBest Companies enters agreement to acquire ABT Molecular Imaging, Inc. and announces creation of Best ABT, Inc.

Best Medical International, Inc. (BMI) and Best Cyclotron Systems (BCS) both part of the TeamBest group of companies, are pleased to announce the creation of Best ABT, Inc. Best ABT, Inc. has entered into an agreement to acquire ABT Molecular Imaging, Inc. (ABT), a Knoxville, TN based cyclotron manufacturing company.

The TeamBest group of companies, founded by Krishnan Suthanthiran, is headquartered in Springfield, Virginia, USA, and manufactures a variety of quality products for the radiation therapy and diagnostic community.

BCS currently offers a wide array of cyclotrons ranging from 15 MeV to 70 MeV. A fully-functioning Best 70 MeV cyclotron has been successfully installed in Legnaro, Italy. BCS is currently installing several other cyclotrons in various countries worldwide.

Best ABT Press Release • Continued

Best ABT, Inc. will be a valuable addition to the TeamBest cyclotron portfolio that will allow TeamBest to deliver quality oncology diagnosis and care to a large group of currently underserved patients worldwide. The acquisition of ABT will bring a wealth of experience in smaller cyclotron technology, as well as in automated chemistry to TeamBest.

The cyclotron manufactured by ABT, the BG-75 Biomarker Generator (BG-75 System) is smaller and easier to install and operate than most conventional systems. The BG-75 integrates a compact cyclotron with micro-chemistry and automated quality control system, to provide on-demand F-18 FDG production in one seamless solution (“Dose-On-Demand”) to support the diagnostic community. With more than 25 BG-75 Systems sold worldwide, Best ABT, Inc. will allow the TeamBest group of companies to expand its global reach into more diverse markets than ever before.

Best ABT Press Release • Continued

With this acquisition, TeamBest is taking another step in delivering on its promise to deliver “healthcare for everyone”. Together with Best Cure Foundation (BCF), the TeamBest group of companies will set up a hub-and-spoke model healthcare delivery system, linked to General, as well as Super-Specialty Medical Centers, availing themselves of all of TeamBest’s new and advanced technologies worldwide.

Best ABT Molecular Imaging

The BG-75 Biomarker Generator is a revolutionary development in radio-pharmaceutical production that delivers a single or batch dose of ^{18}F -FDG, and additional advanced ^{18}F biomarkers, “on demand”. The system provides integration of all components needed to produce and qualify PET biomarkers into a single, self-contained system that occupies a fraction of the space required by conventional solutions, simplifying the implementation of PET.



Best ABT Molecular Imaging

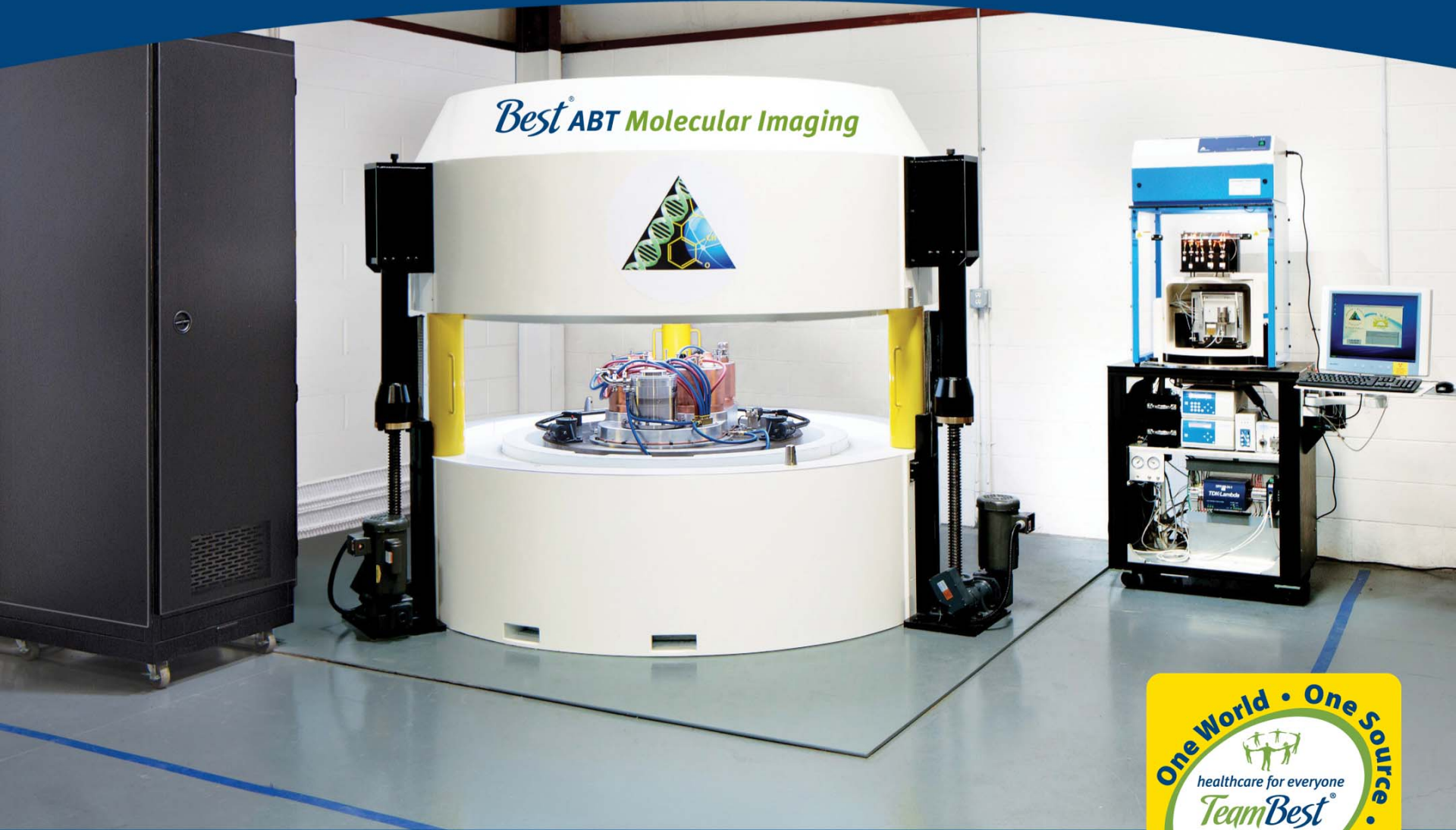

Best ABT Molecular Imaging

The BG-75 Biomarker Generator integrates a compact mini-cyclotron, kit based micro-chemistry, and automated quality control, simplifying in-house production of ^{18}F -FDG and advanced biomarkers.

- Push button graphic interface
- Kit based chemistry
- Single or batch dose production
- Final dose delivery to syringe or vial (option)
- Automated quality control testing
- Integrated cyclotron & chemistry self-shielding
- Complete production lab in a 30²m area



Best ABT Molecular Imaging



Best Cyclotron Systems

For Research & Radioisotope Production



TeamBest® Cyclotron Designs

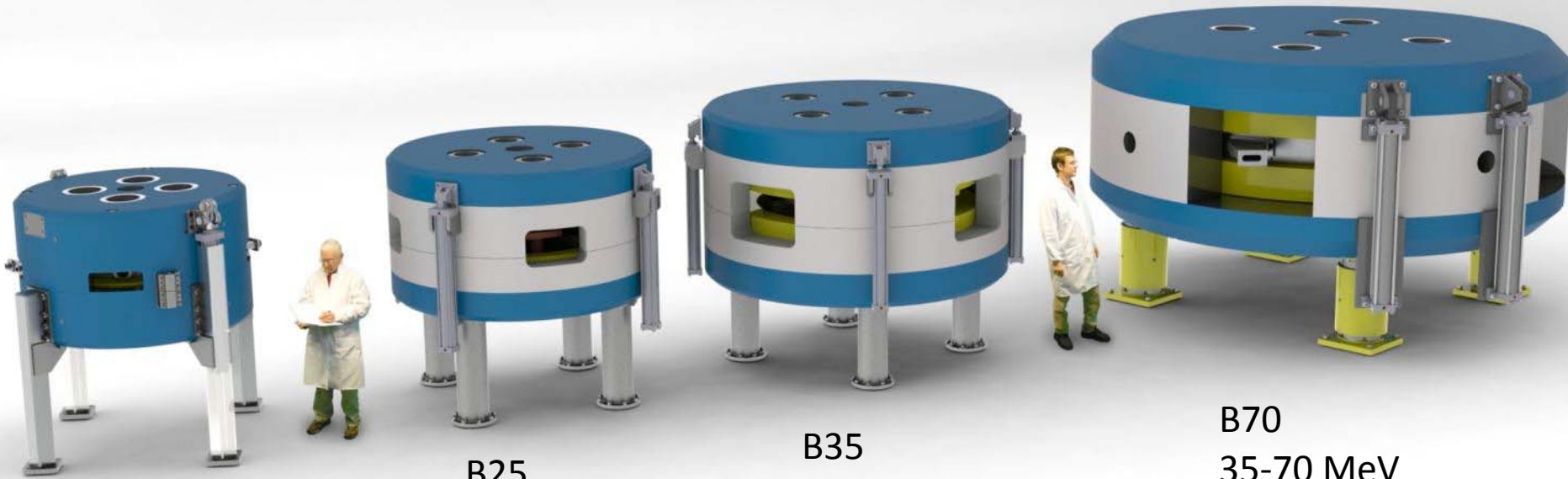

B15 PET
15 MeV
400 μ A
Targets
Radiochem

B25
20-25 MeV
400 μ A
Targets
Radiochem

B35
15-35 MeV
1000 μ A
Targets
Radiochem

B70
35-70 MeV
1000 μ A
Targets
Radiochem



Best Cyclotron Systems

Cyclotron	Energy (MeV)	Isotopes Produced
Best 15	15	^{18}F , $^{99\text{m}}\text{Tc}$, ^{11}C , ^{13}N , ^{15}O , ^{64}Cu , ^{67}Ga , ^{124}I , ^{103}Pd
Best 20u/25	20, 25–15	Best 15 + ^{123}I , ^{111}In , $^{68}\text{Ge}/^{68}\text{Ga}$
Best 30u (Upgradeable)	30	Best 15 + ^{123}I , ^{111}In , $^{68}\text{Ge}/^{68}\text{Ga}$
Best 35	35–15	Greater production of Best 15, 20u/25 isotopes plus ^{201}Tl , $^{81}\text{Rb}/^{81}\text{Kr}$
Best 70	70–35	$^{82}\text{Sr}/^{82}\text{Rb}$, ^{123}I , ^{67}Cu , ^{81}Kr + research

Best Cyclotron Systems provides 15/20/25/30/35/70 MeV Proton Cyclotrons as well as 35 & 70 MeV Multi-Particle (Alpha, Deuteron & Proton) Cyclotrons

- Currents from 100uA to 1000uA (or higher) depending on the particle beam are available on all BCS cyclotrons
- Best 20u to 25 and 30u to 35 are fully upgradeable on site



Best Cyclotron Systems

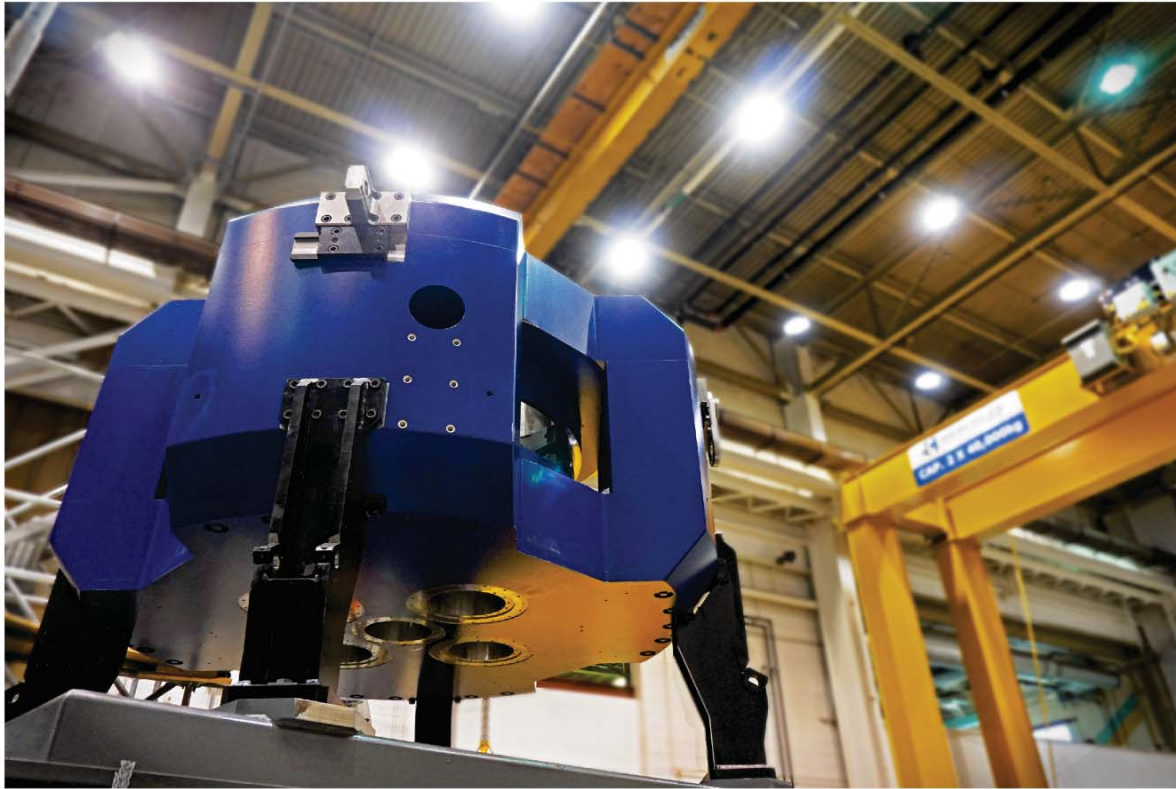

Assembly of a
Best 35 MeV
Cyclotron
at Best
Theratronics
facility, Ottawa,
Ontario, CA



Best Cyclotron Systems



Installation of
Best 70 MeV
Cyclotron at
Italian National
Laboratories
(INFN),
Legnaro, IT



Installation of 70MeV Cyclotron

May 2015 - Legnaro, Padova, Italy



Installation of 70MeV Cyclotron

May 2015 - Legnaro, Padova, Italy



Inauguration of 70 MeV Cyclotron at INFN

December 2016 - Legnaro, Padova, Italy



Front Page News in Padova, Italy

IL GAZZETTINO
Sabato 3 Dicembre 2016

TRATTORIA Ora 7.30
cucina tipica veneta
cucina veneziana
10142 Padova - Via Venezia 7
Tel. 049 8700000 - 049 8700001
www.ora730.it - e-mail: info@ora730.it

IL SANTO DEL GIORNO
Santo Spirito

IL PROCESSO
La polizia più d'urto più va più cattura

IL SOLE
Soleggiato con nuvole sparse

IL TEMPO OGGI
12°C / 18°C

IL TEMPO DOMANI
14°C / 20°C

DUE PALAZZI Dopo il caso del boss che gestiva un traffico di droga, inchiesta su altri 10 reclusi
Indagine sui permessi agli ergastolani
Mafiosi e assassini detenuti in regime di alta sicurezza sono stati "lasciati" in carceri comuni

LAPROCURA
È stata aperta un'inchiesta. Procura su dieci detenuti. Due Palazzi che dal reato di alta sicurezza sono "declassati" a reclusi comuni, quindi con possibilità di permesso premiale. I carceri stanno indagando capire che ha voluto "arruolare" la loro permanenza dietro alle sbarre e perché.

PRECEDENTI
Il Due Palazzi era già in nel mirino della Procura. La prima volta, nel luglio del 2015, fu scoperto che un boss catturato si era recato a Padova su un traffico di droga internazionale.

PALESTRO I banditi seguono l'anziana dalle Poste alla parrucchiera: irruzione col taglierino

Prende la pensione, rapinata in negozio

San Lazzaro, Zaia attacca:
«Se qualcuno ci rallenta»

Fisica nucleare, il futuro è a Padova
Inaugurato a Legnaro il ciclotrone da 170 tonnellate

ACCIDENTE
È stato inaugurato un artificio nucleare di fisica nucleare (accidente "Sant'") spaziale e tecnologico da 170 tonnellate che ospiterà le particelle veloci grazie agli acceleratori nella regione a valle nucleare componentistica dei materiali.

2300
alle pagine 3 e 4

il mattino
di Padova
Sabato 3 Dicembre 2016

NATALE Neve artificiale in via Santa Lucia, trasformata in "The Christmas street"

-50%

IN TUTTO IL NEGOZIO

2. I RISPARMI SENZA LA FIDUCIA
GIORGIO CRASSIN
C'è un problema che non si risolve. Il problema è che i risparmiatori non hanno fiducia nei risparmiatori. Il problema è che i risparmiatori non hanno fiducia nei risparmiatori. Il problema è che i risparmiatori non hanno fiducia nei risparmiatori.

I padovani al voto
Carraro: Paese fermo
Rolle: false promesse

L'URNA E IL DESTINO DEL CREDITO
IL BRUNO MANFELLOTTI
Ora, con la riforma del credito, si apre una nuova fase della vita del credito. Si apre una nuova fase della vita del credito. Si apre una nuova fase della vita del credito.

Css, il Comune fa dietrofront
Decide la polizia errata. I comitati ricorrono allo stesso

INNAUGURATO ALL'INFINITO DI LEGNARO
Ecco il super-ciclotrone che aiuta a curare i tumori

Popolari riforma sos
Uno stop a Bankitalia

Messa in piega con la rapina
Due banditi irrompono dalla parrucchiera e aggrediscono una cliente

ARABO, PIAZZA SACRO CUORE
Aversa cancella Tarazona sull'asfalto

CARCERE DUE PALAZZI
Detenuti declassati aperta un'inchiesta

SENTENZA A SALVATRANO



70 MeV Cyclotron at INFN



Best Particle Therapy ion Rapid Cycling Medical Synchrotron (iRCMS)



Collaboration with the Best in the World

In 2009, **Best Medical International (BMI)** and **Brookhaven National Laboratory (BNL)** signed an agreement called **CRADA** (**C**ooperative **R**esearch **A**nd **D**evelopment **A**greement)

The mandate was to develop an **ion Rapid Cycling Medical Synchrotron (iRCMS)**



BNL (USA) Particle Accelerators

0.75 MeV to 250 GeV



Proton therapy precisely targets tumors, reducing the radiation dose to healthy tissue compared with X-rays¹

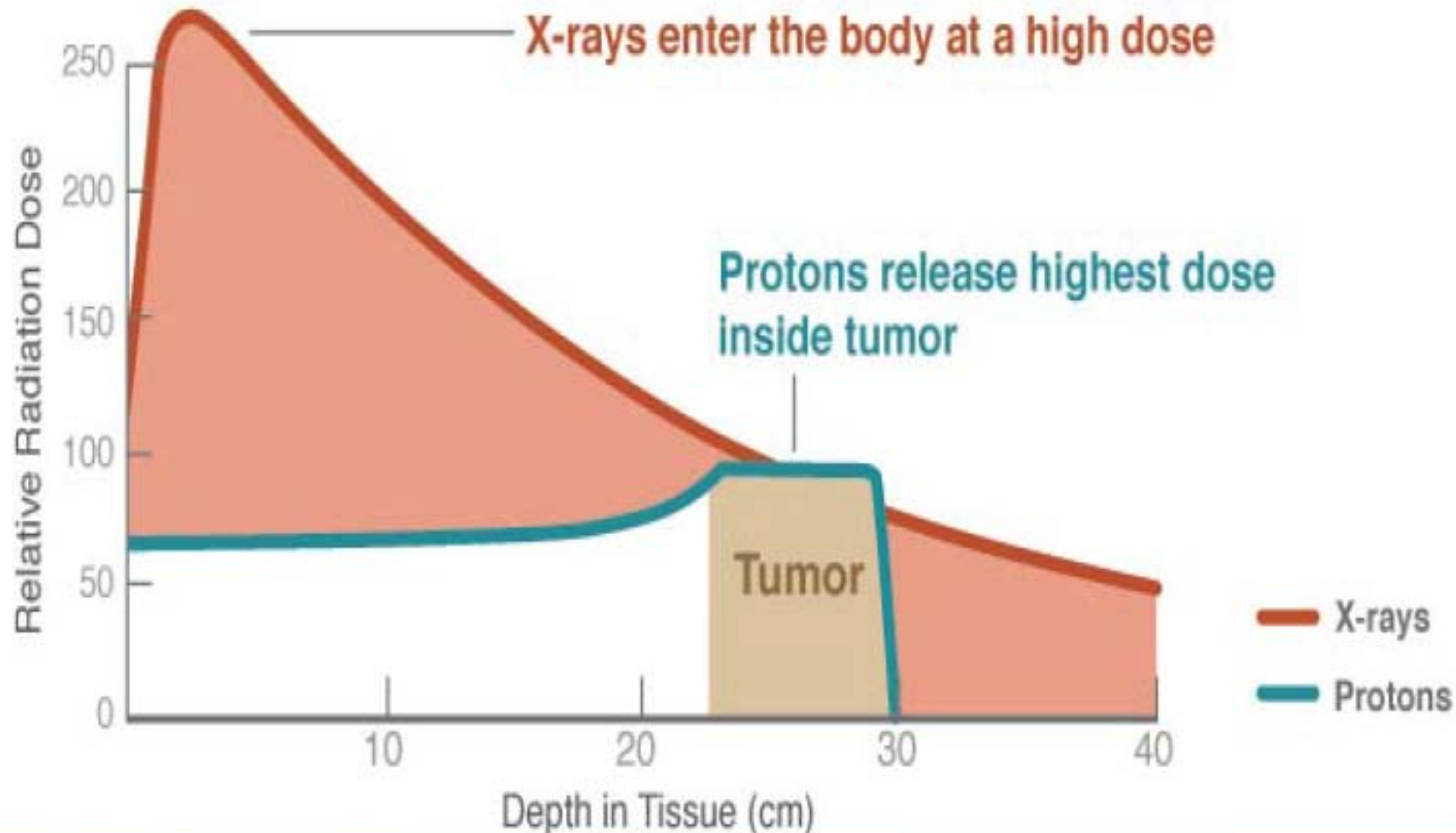

1946 "Radiological Use of Fast Protons" and discovery of the Bragg Peak

ROBERT R. WILSON  Research Laboratory of Physics, Harvard University

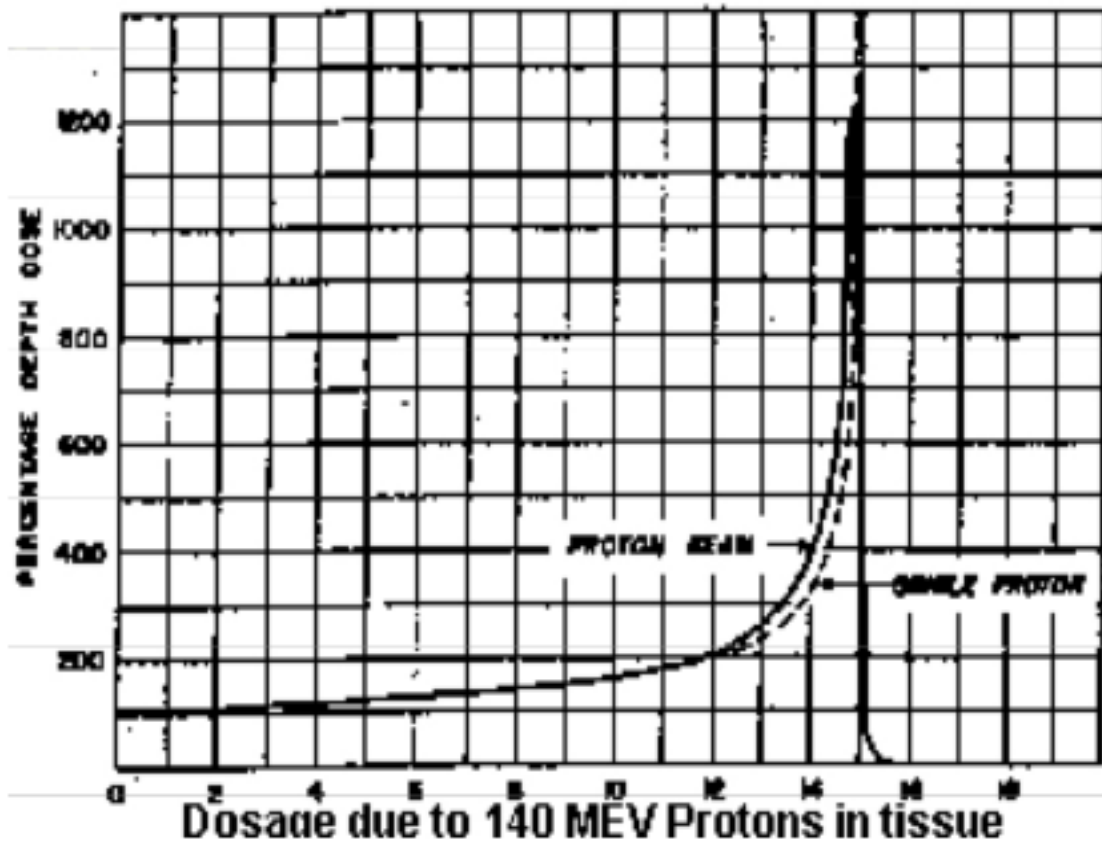

High energy
dose at the end
of path (**Bragg
peak**)

Comparison of gamma ray radiation dose with proton doses

Absorbed dose (%)

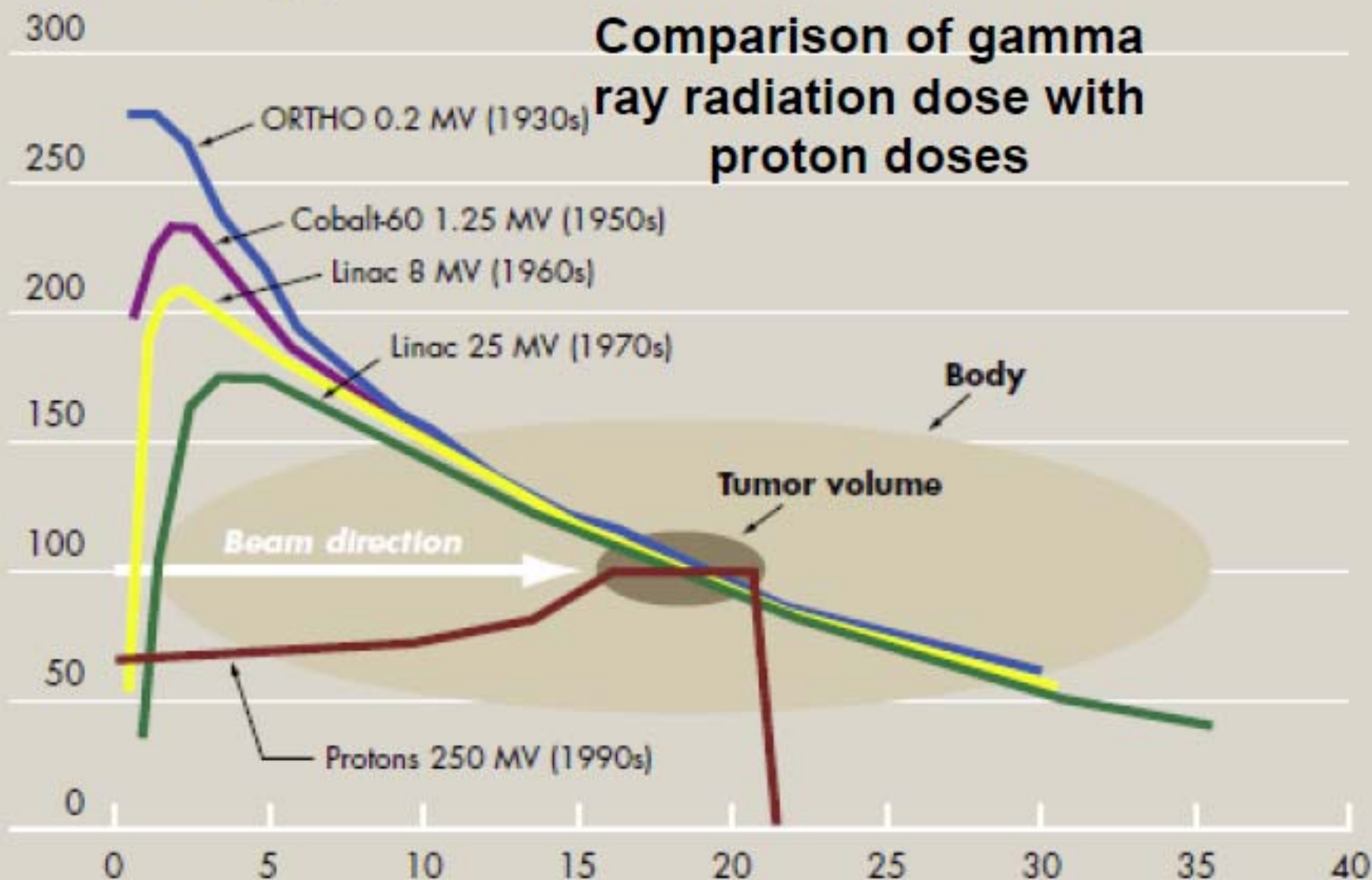

Protons and carbon ions deliver more directed radiation to the tumor – Bragg Peak

FIGURE 1 Dose distribution of protons versus x-rays.

Destroying Cancer DNA



DNA

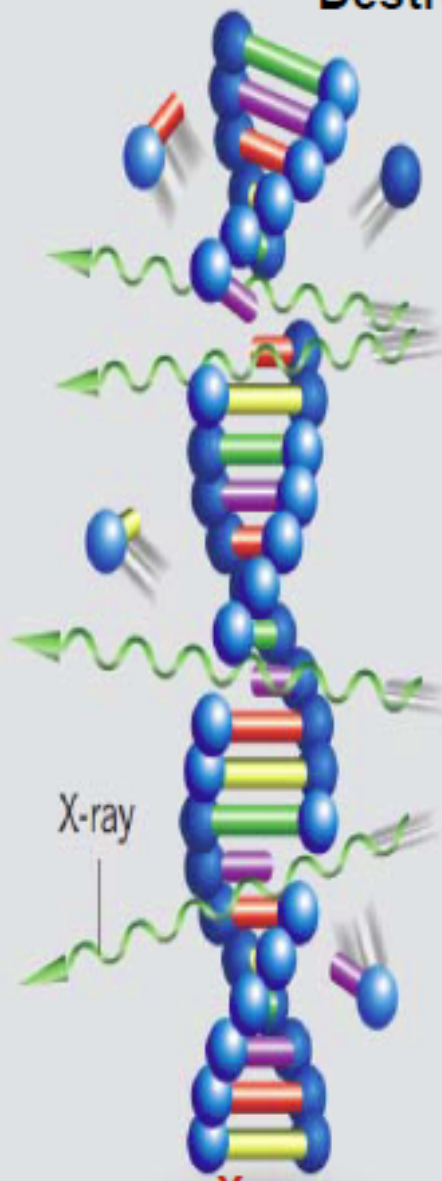

X-ray

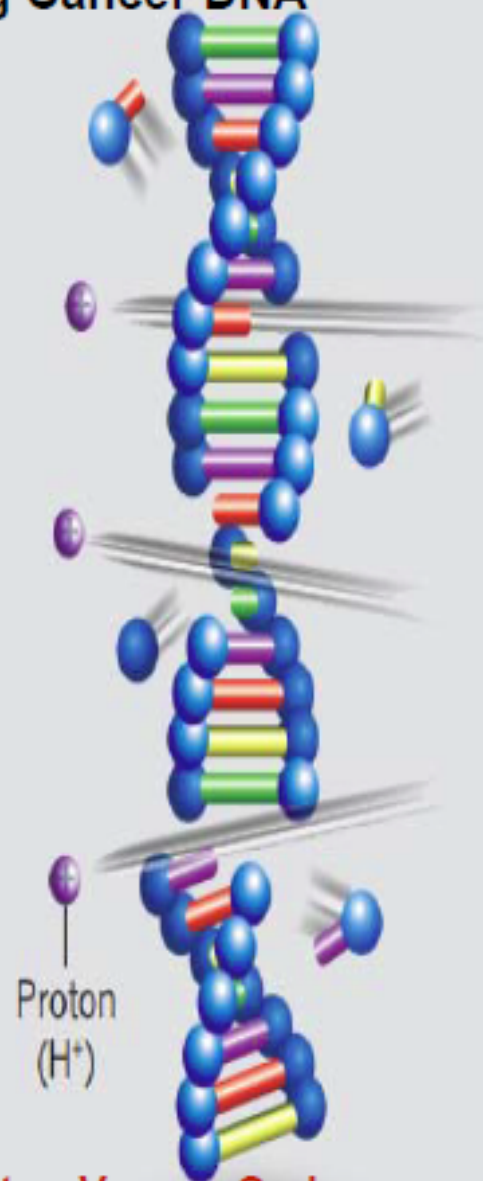

Proton beam

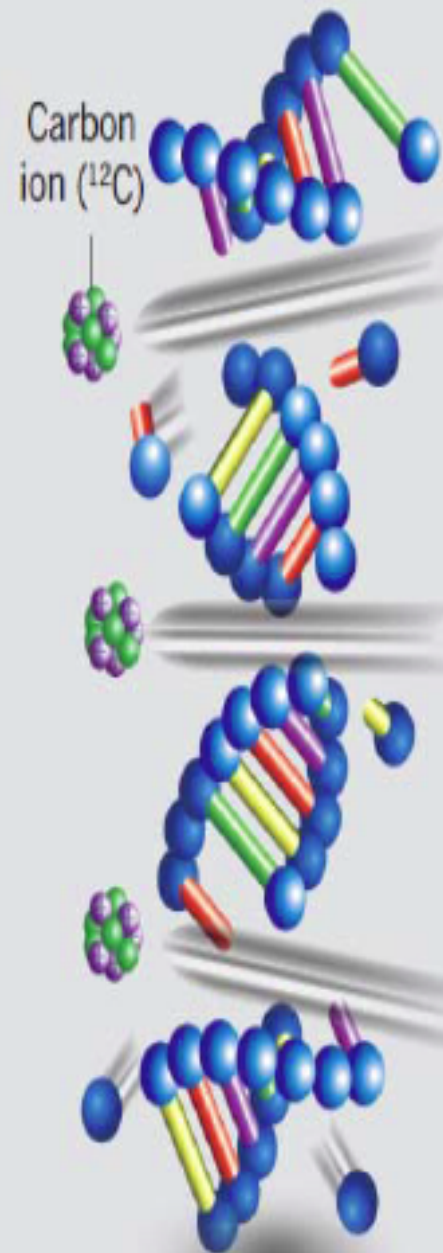

Carbon-ion beam

X-ray versus Proton Versus Carbon
Minor Damage done by Protons are reversible
Carbon chops up the DNA and does irreparable damage

Expandable from Single-Room to Multi-Room

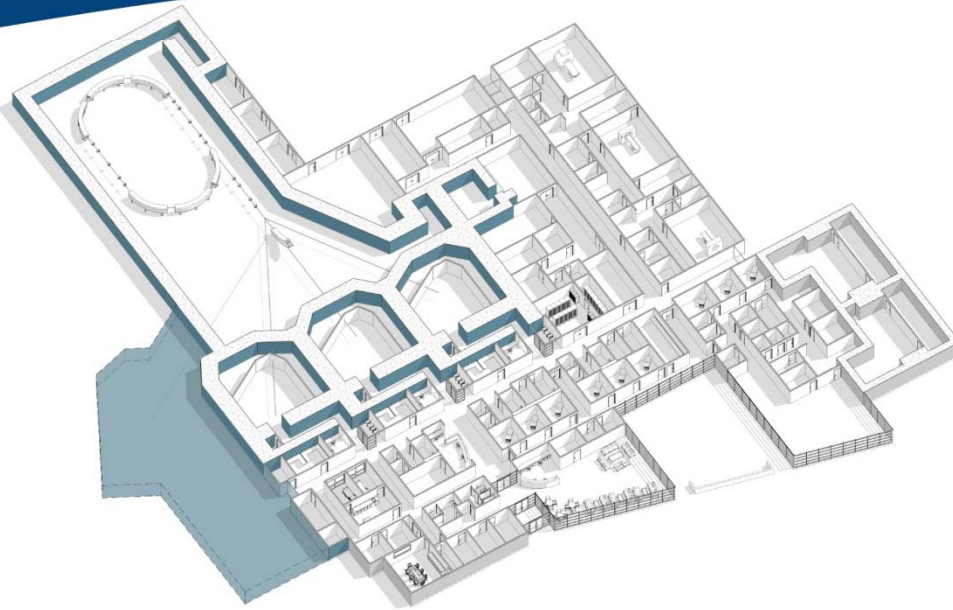

400 MeV Rapid Cycling Medical Synchrotron for Proton-to-Carbon Heavy Ion Therapy:

- Intrinsically small beams facilitating beam delivery with precision
- Small beam sizes – small magnets, light gantries – smaller footprint
- Highly efficient single turn extraction
- Efficient extraction – less shielding
- Flexibility – heavy ion beam therapy (protons and/or carbon), beam delivery modalities

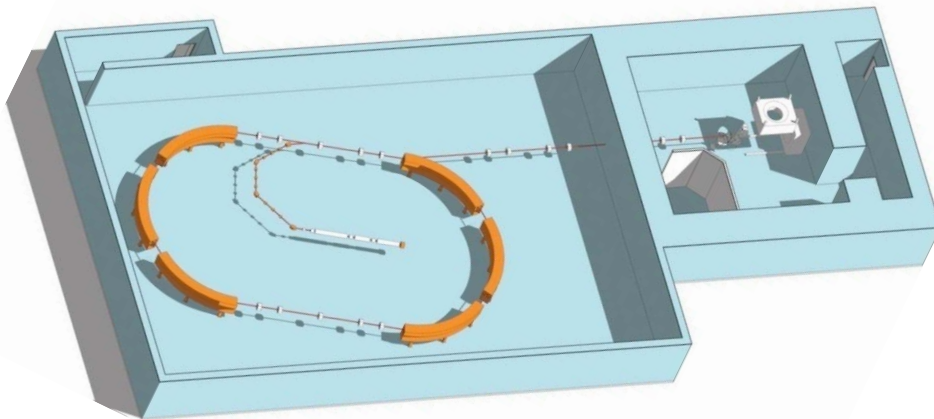

Typical Treatment Rooms

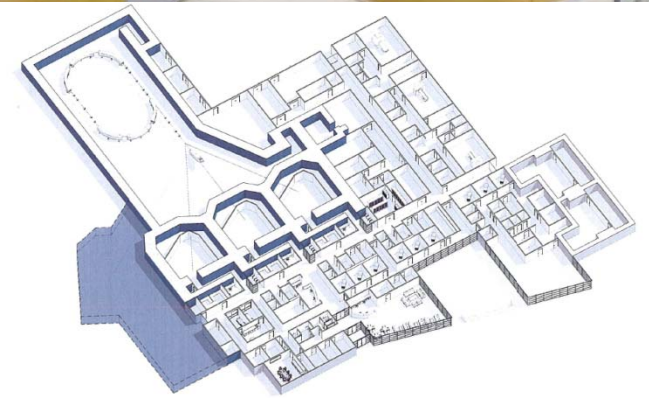
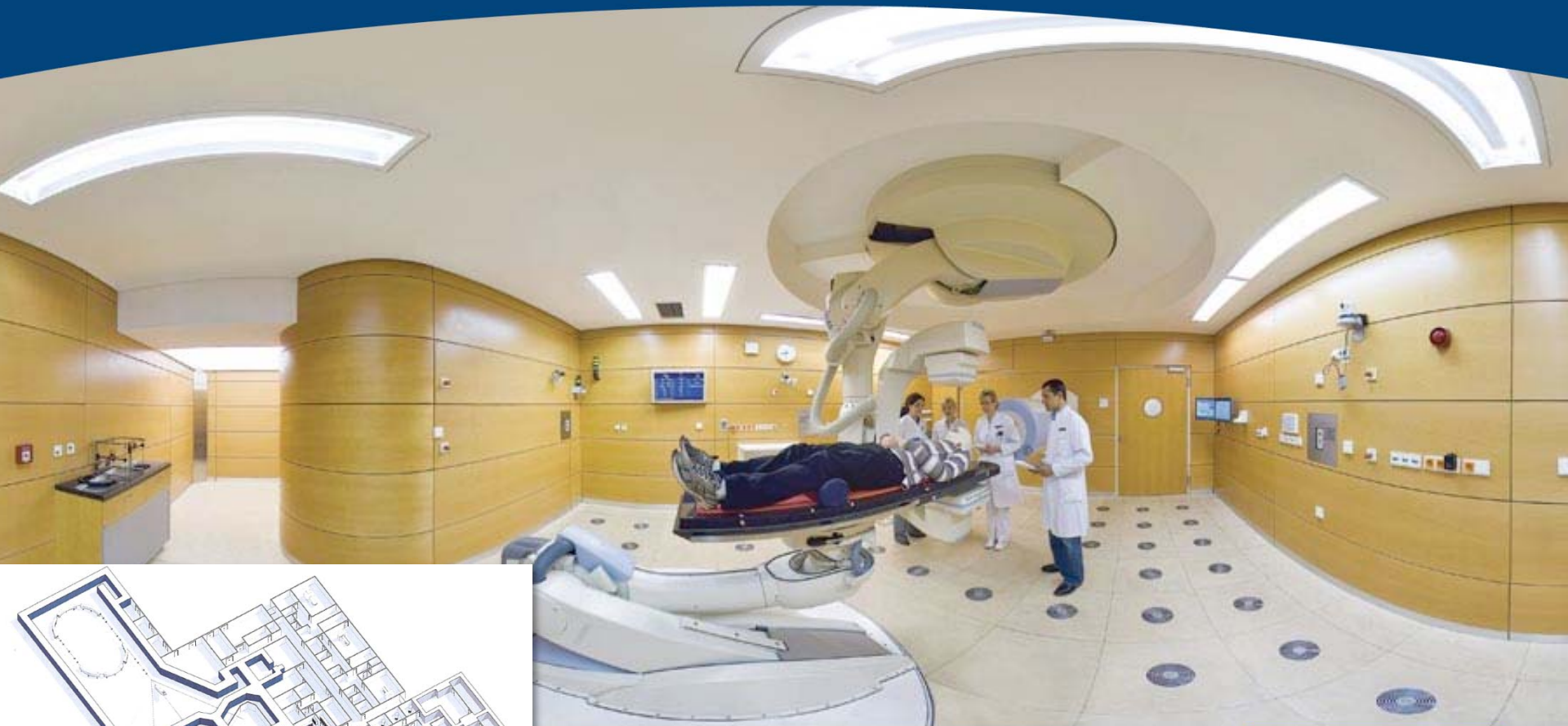

Multi-Room Solution

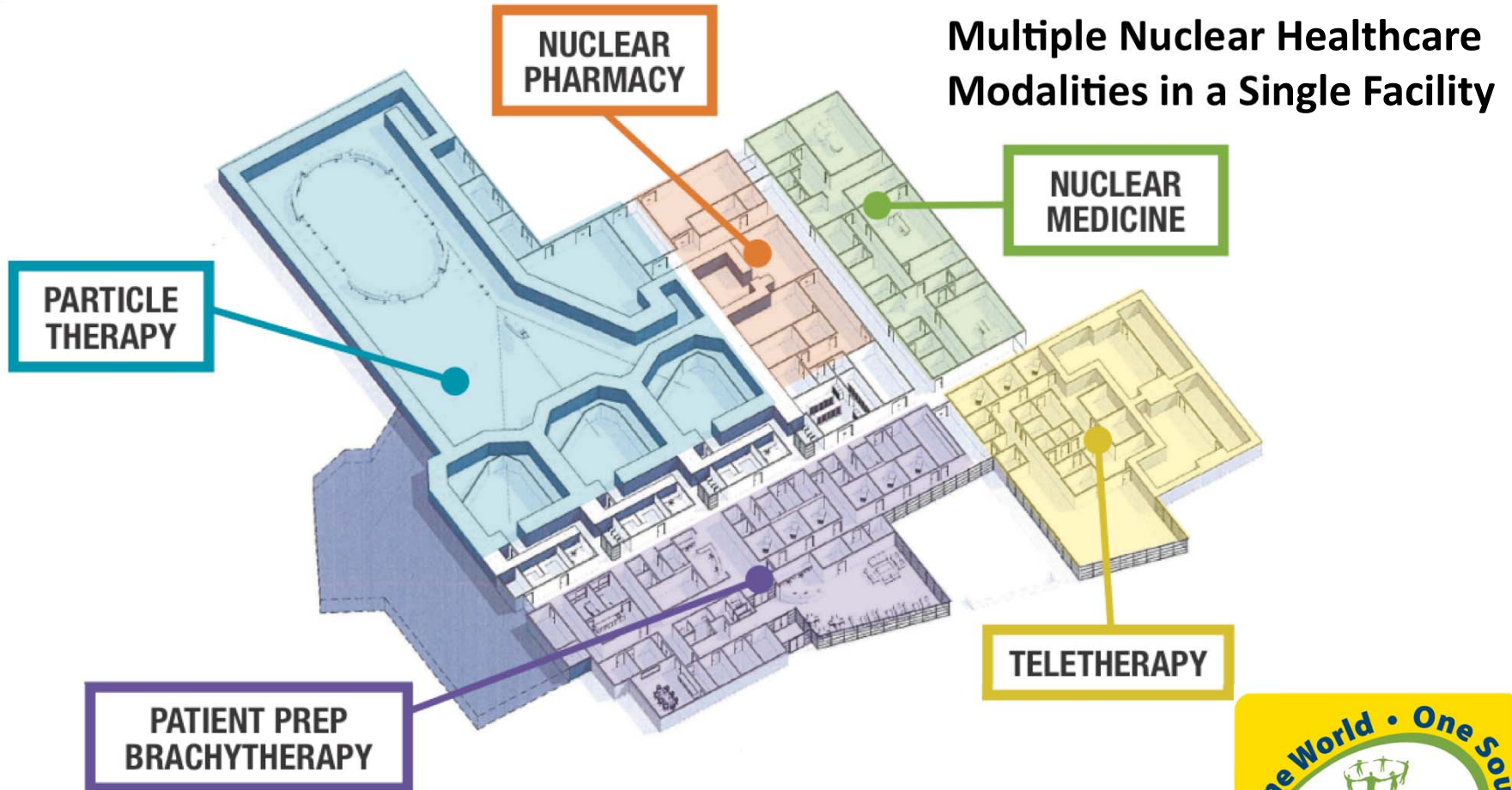

Single-Room Solution



Supine CT Verification

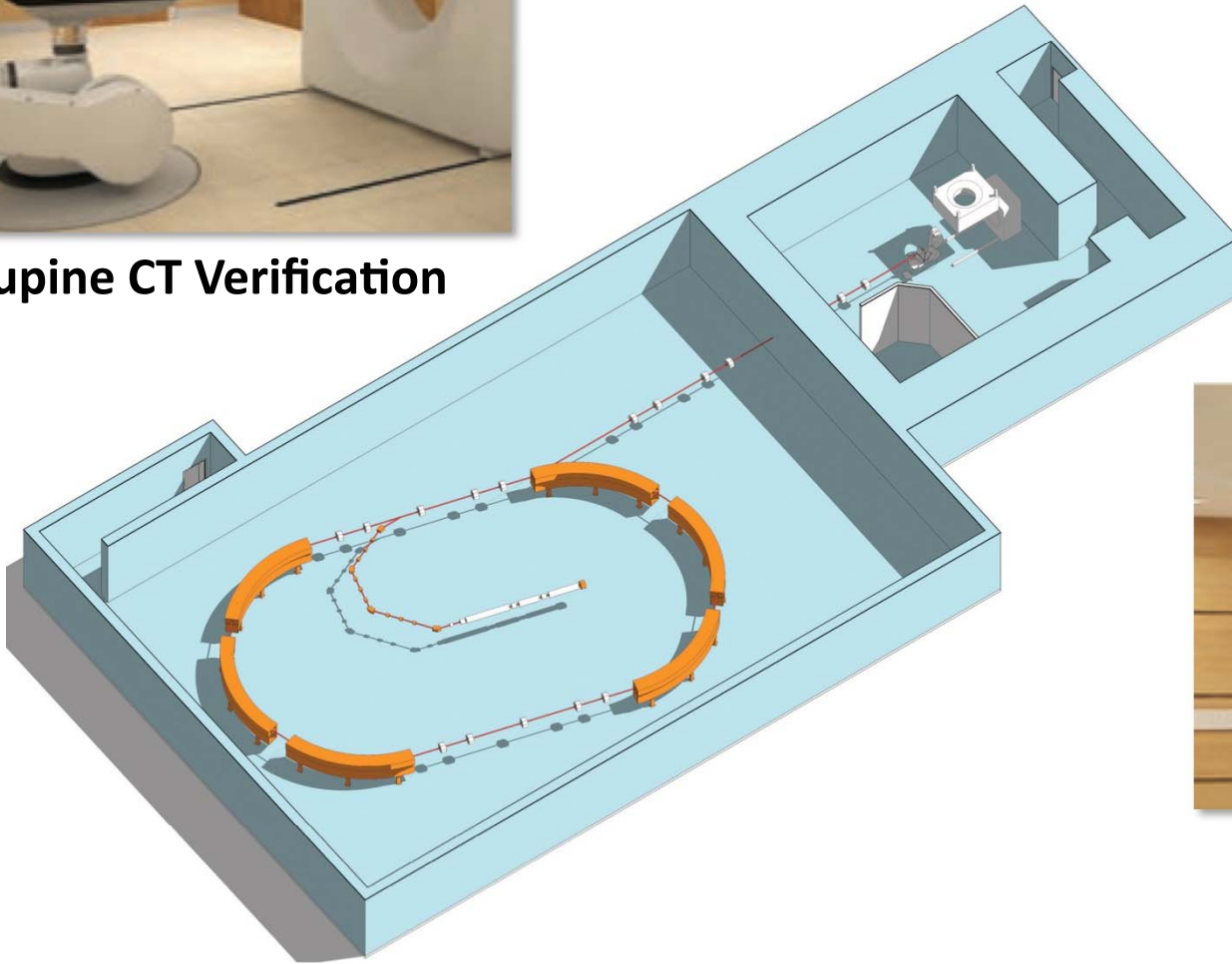

Seated CT Verification



BEST / BNL iRCMS – Much Smaller Footprint

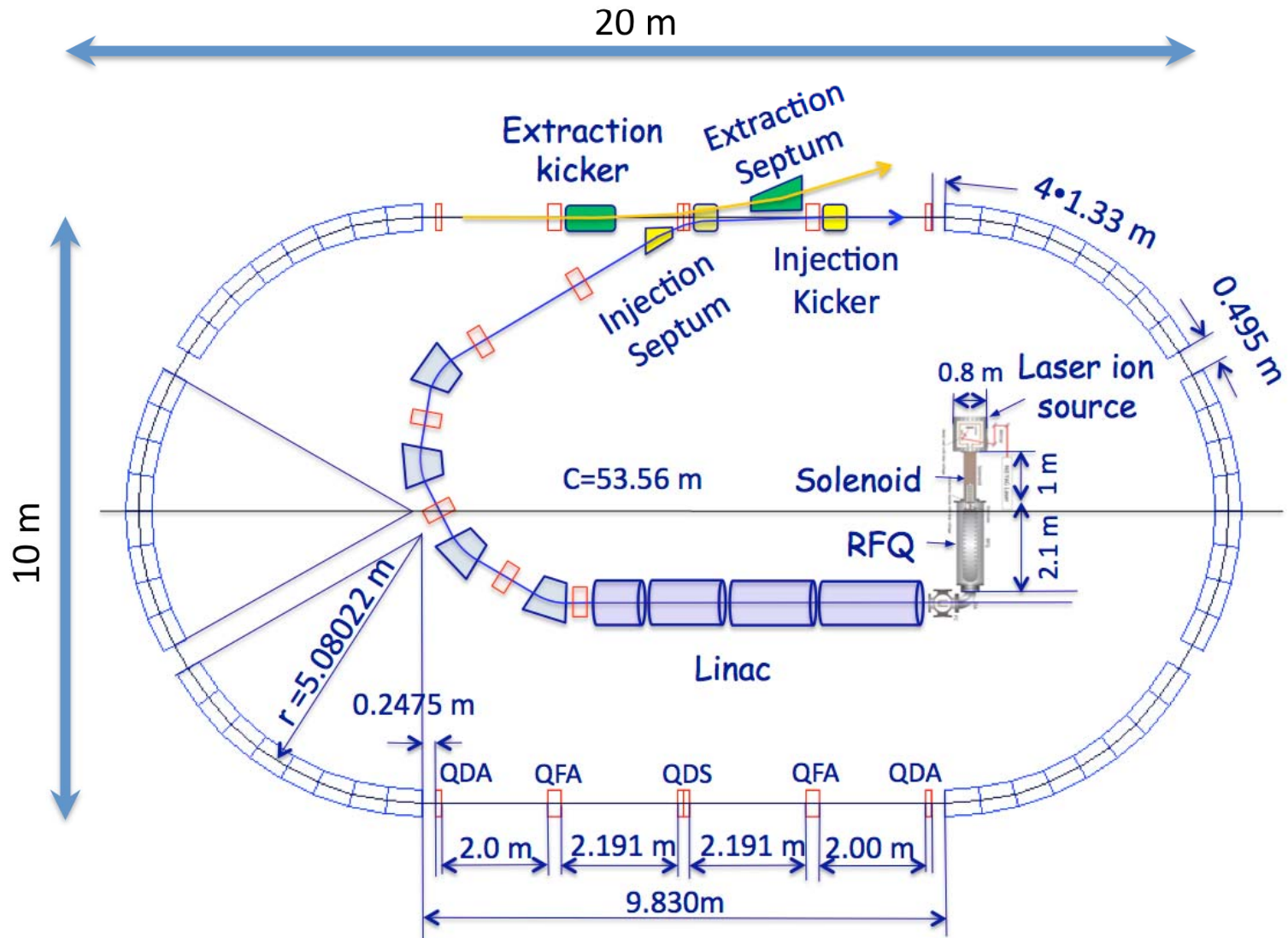

Racetrack Synchrotron

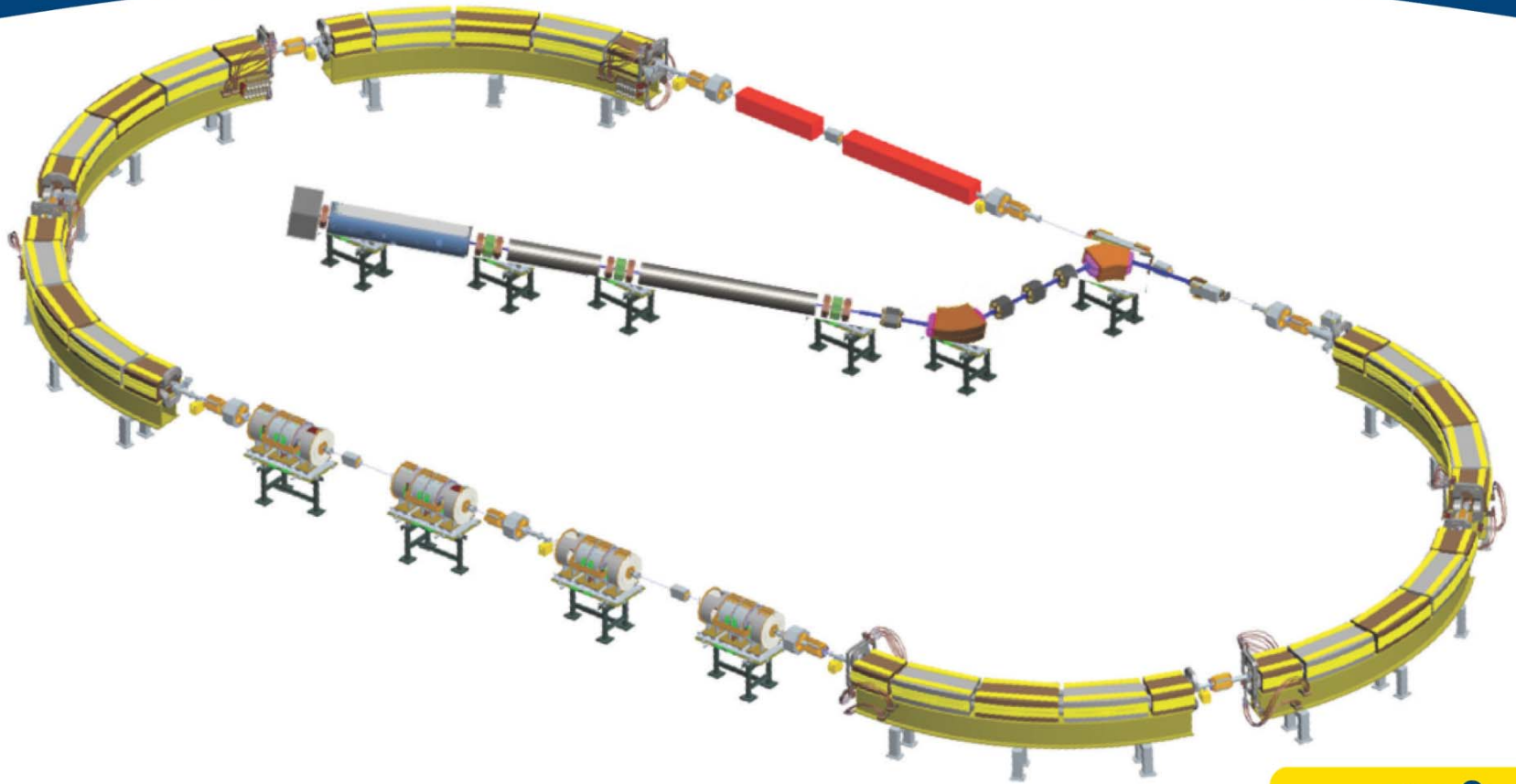

Shielding Estimate Comparisons

Accelerator Comparison Table

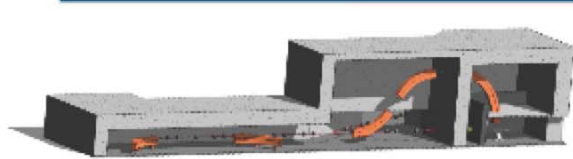

				Maximum Credible Incidence (MCI)	
	Energy Maximum (MeV)	Avg. Current Delivered (nA)	Charge Accelerated (nC/s)	Risk Ratio MCI/Delivered	Shielding (50 mSv/yr) Concrete @10.00 m (m)
Protons (206 MeV)					
Isochronous Cyclotron (NC)	230	2	1250	625	2.89
Isochronous Cyclotron (SC)	250	2	313	156	2.44
Synchro Cyclotron (SC)	250	2	1	0.50	0.54
Slow Cycle Synchrotron	250	2	20	10	1.53
Rapid Cycle Synchrotron	1200	2	0.133	0.067	0.13

Estimates above were calculated using the Moyer Model
 Neutron source terms for 177 MeV protons
 Neutron transmission factors
 Neutron attenuation length in concrete (SLAC PUB 130339)

Final shielding calculations use a full scale Monte Carlo method
 (MCNPX, GEANT, FLUKA)



Prototype iRCMS Combined Function Magnet



RBE: Relative Biological Effectiveness

OER: Oxygen Enhancement Ratio

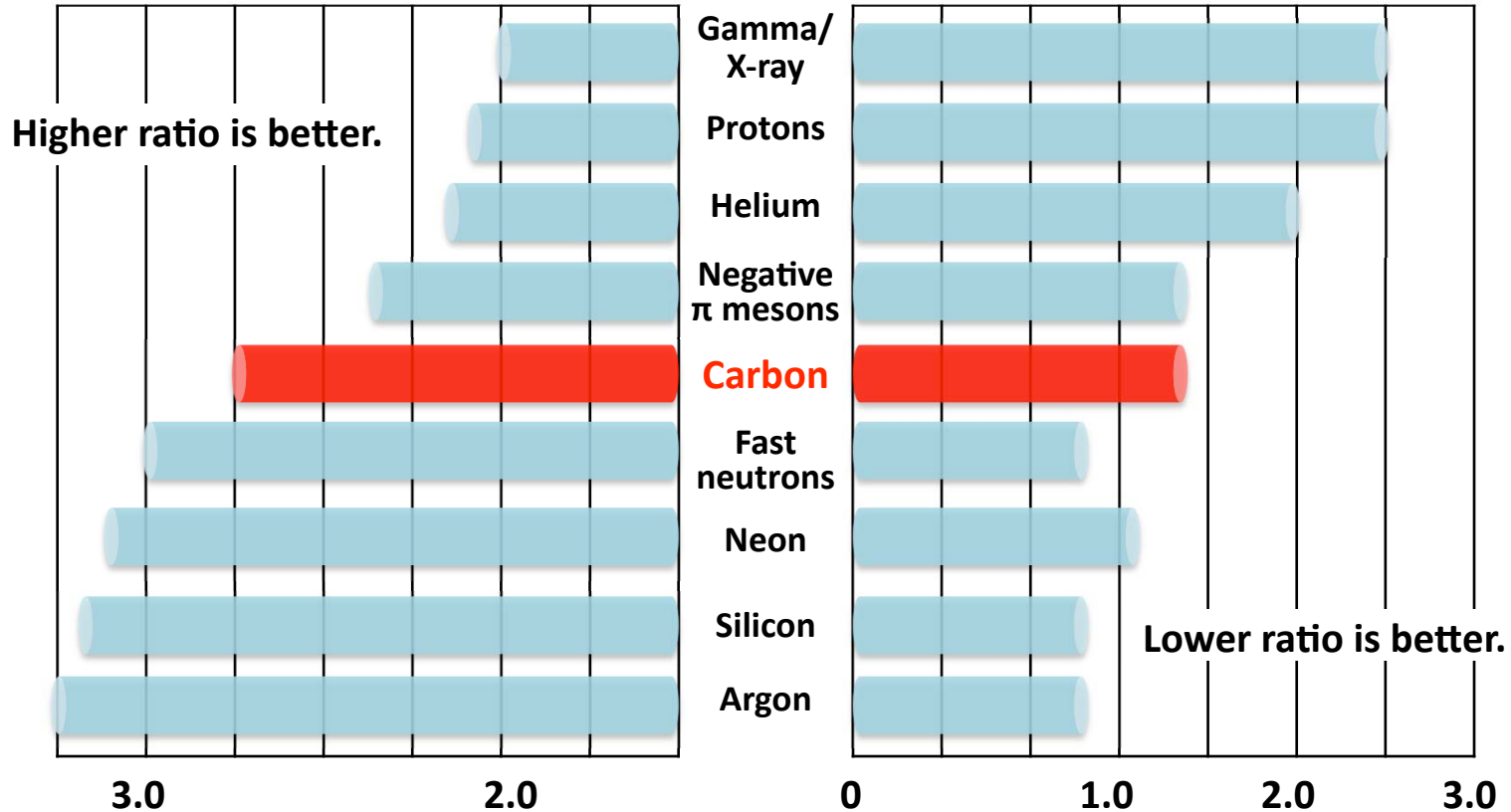

RBE represents the biological effectiveness of radiation in the living body. The larger the RBE, the greater the therapeutic effect on the cancer lesion.

OER represents the degree of sensitivity of hypoxic cancer cells to radiation. The smaller the OER, the more effective the therapy for intractable cancer cells with low oxygen concentration.

Clinical Comparison: X-rays vs. Protons vs. Carbon Ions

When the ratios of peak to plateau (a/b) are compared while considering biological effect, the carbon beam has the largest value.

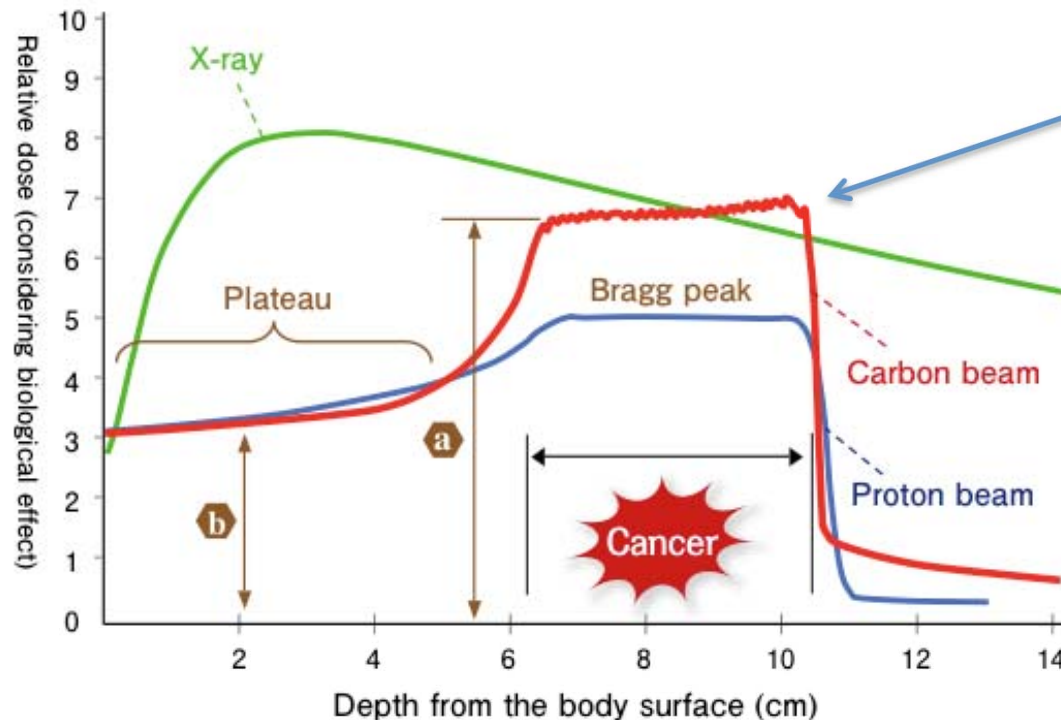

Spread out the Bragg Peak to match tumor volume

Protons – Base/Peak = 60% Carbon Ions – Base/Peak = 45%



Carbon Ions are more precise than Protons

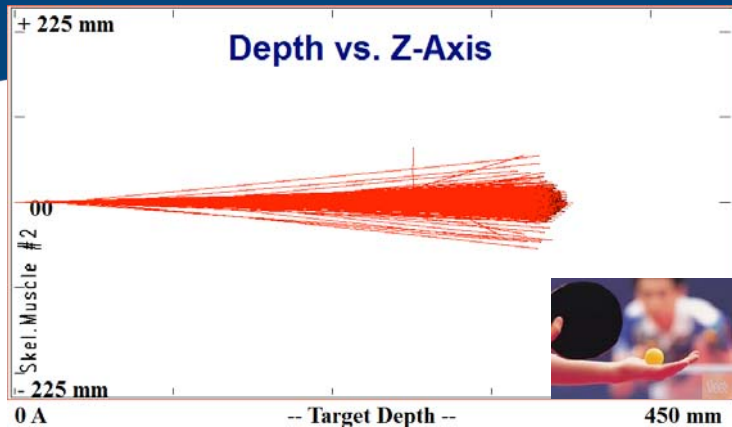

The intrinsic spot width for ~206 MeV/u **protons** is $2\sigma = 11.4$ mm

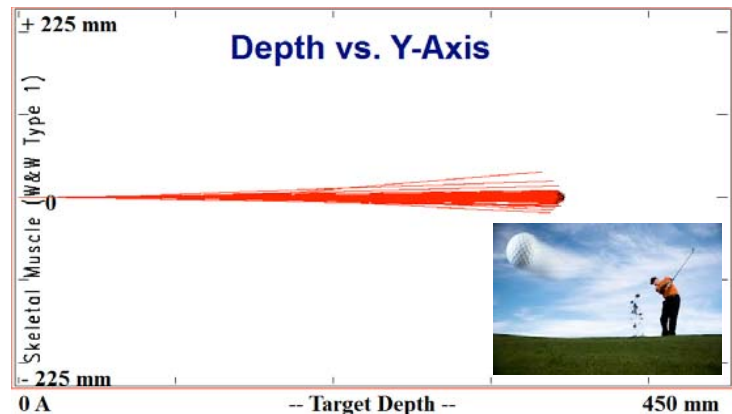

The intrinsic spot width for ~400 MeV/u **carbon** ions is $2\sigma = 2.93$ mm

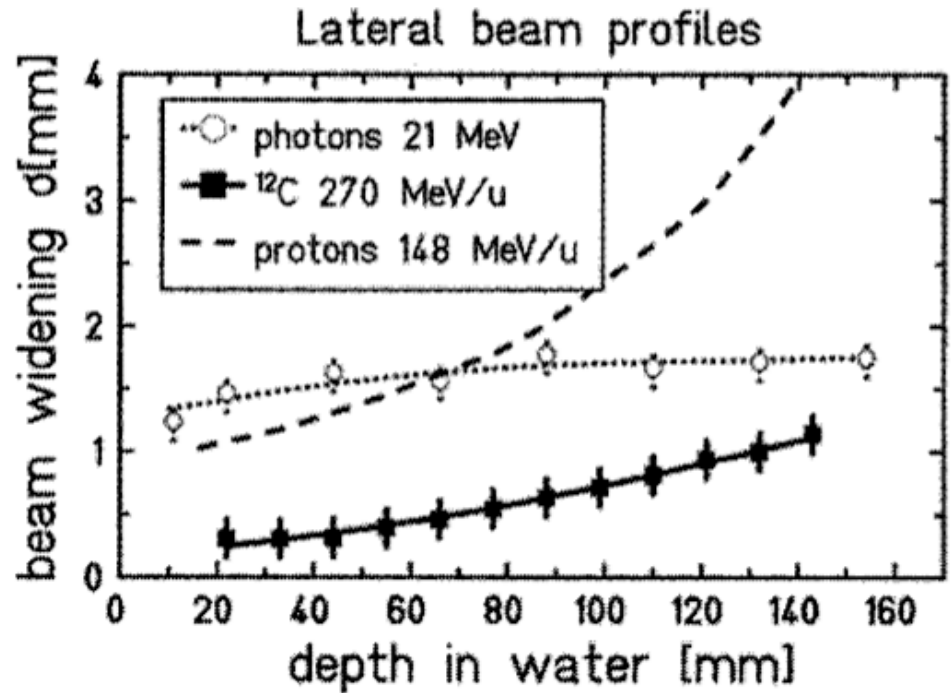

"Lines to guide the eye"
U. Weber GSI (1996)



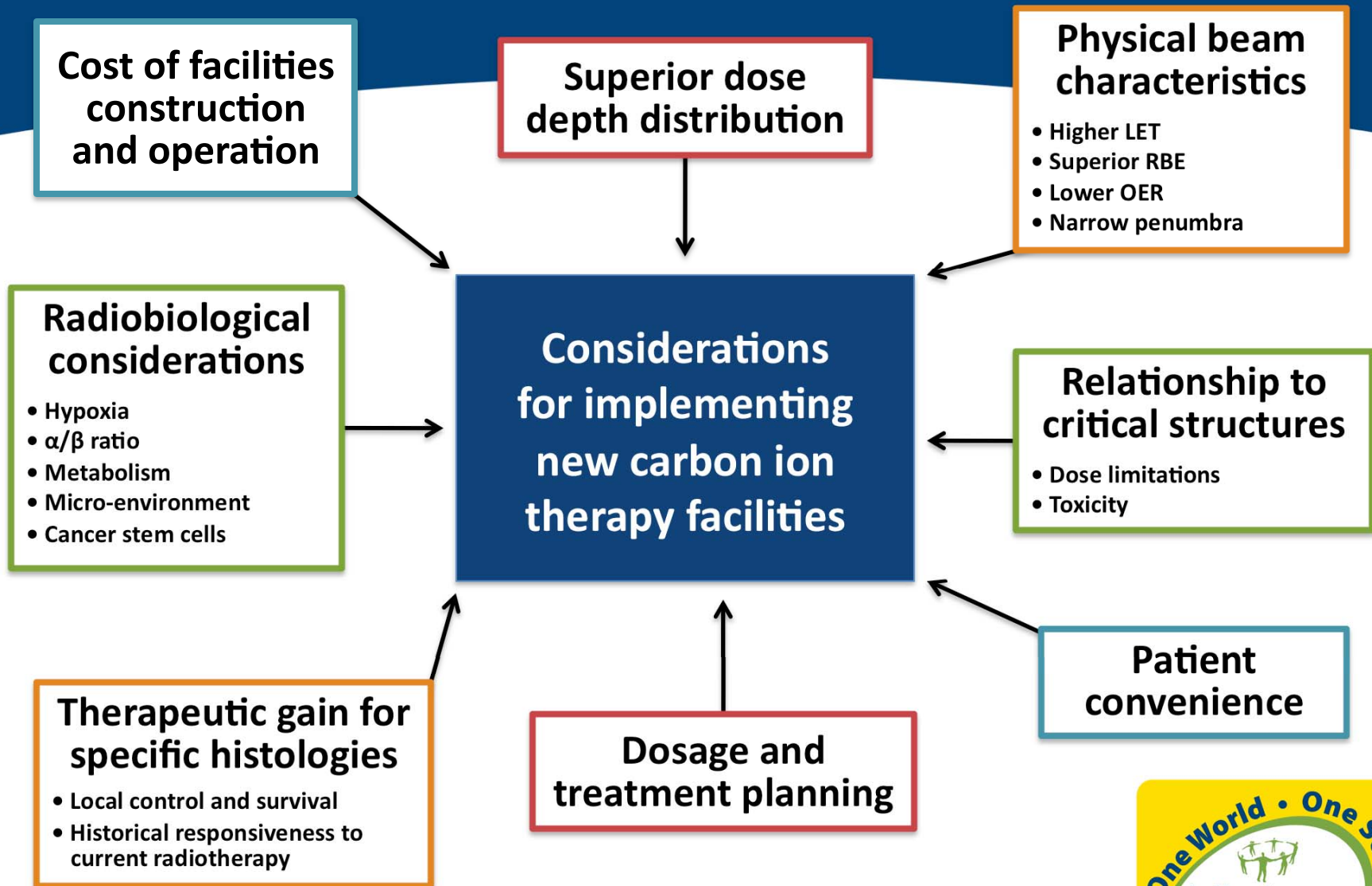

Medical Advantage

- Deliver 20 times the cancer killing power of protons
- Cure the patient 4 to 10 times faster

Benefit to Patient

- Shorter treatment times – potentially 4 to 10 times less
- Less stress for the patient physically, emotionally & financially
- Less unnecessary radiation exposure

Benefit to Society

- A Heavy Ion Center will provide maximum advantage to the general public by having the capability to treat many more patients than a Proton Center with the same number of treatment rooms

Best Supplies Proton Systems Upgradeable to Carbon!

TREATMENT PLANNING SYSTEM

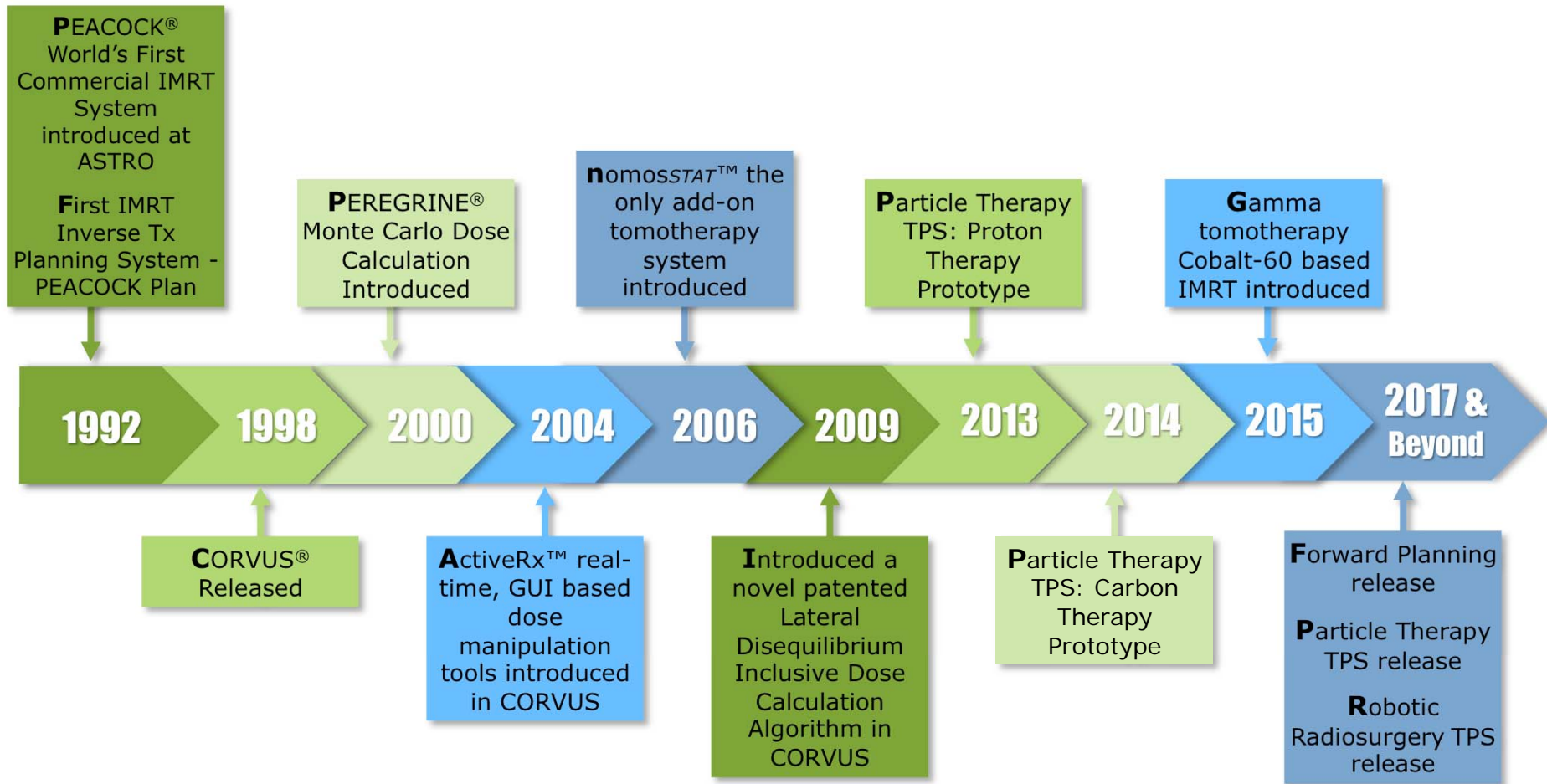

Particle Therapy:

- Proton and Carbon with Best's Rapid Cycling Synchrotron (collaboration with BNL)
- Algorithm verification in collaboration with MGH

Summary

BMI & BNL have jointly developed a rapid cycling proton/carbon synchrotron that enables advanced features including:

- A unique combination of advanced spot scanning with rapid energy modulation
- Elimination of neutron contamination associated with patient specific hardware

Rapid cycling technology has several natural advantages:

- Intrinsically small beam emittances facilitating beam delivery with unprecedented precision
- Small beam sizes – small magnets, light gantries – smaller footprint
- Highly efficient single turn extraction
- Efficient extraction, less charge per bunch – less shielding
- Flexibility – protons and or carbon, future beam delivery modalities



State of the Art Manufacturing Facilities



**Best NOMOS (Pittsburgh, PA) &
Best Theratronics (Ottawa, ON)**



Assembly

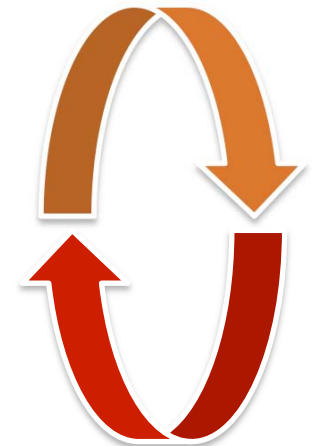

**Heavy
Manufacturing**

Exhibitions, Meeting & Trade Shows



AAPM 2016 – Washington, DC



AAPM 2016 – Washington, DC



ASTRO 2016 – Boston, MA



ASTRO 2016 – Boston, MA



ICC 2017 Best Exhibitor Award



Team Best won the
Best Exhibitor Award
at the 2nd Indian Cancer
Congress 2017
Bangalore, India



Recent Recognition



Awards and Speaking Engagements

Keynote Speaker – Global Health Catalyst Cancer Summit

April 29, 2016, Harvard Medical School, Boston, MA



Awards and Speaking Engagements

Power of One Award - Patcha Foundation

October 29, 2016, Laurel, MD





Awards and Speaking Engagements

International Man of the Year Award –U.S. Congressman Danny K Davis's Multi Ethnic Advisory Task Force

October 30, 2016, Meadows Club, Rolling Meadows, IL



U S Congressman Danny K. Davis
7th Congressional District - IL
Multi Ethnic Advisory Task Force
6th Annual Congressional Awards Gala



Awards and Speaking Engagements

**Fastest Growing Indian
Company Excellence Award
10th International Achievers
Summit on Global Corporate
Achievements & Social
Responsibilities**

**Friday, April 20, 2018
Bangkok, Thailand**





WWW.KITSAULTENERGY.COM





WWW.KITSAULTENERGY.COM





WWW.KITSAULTENERGY.COM

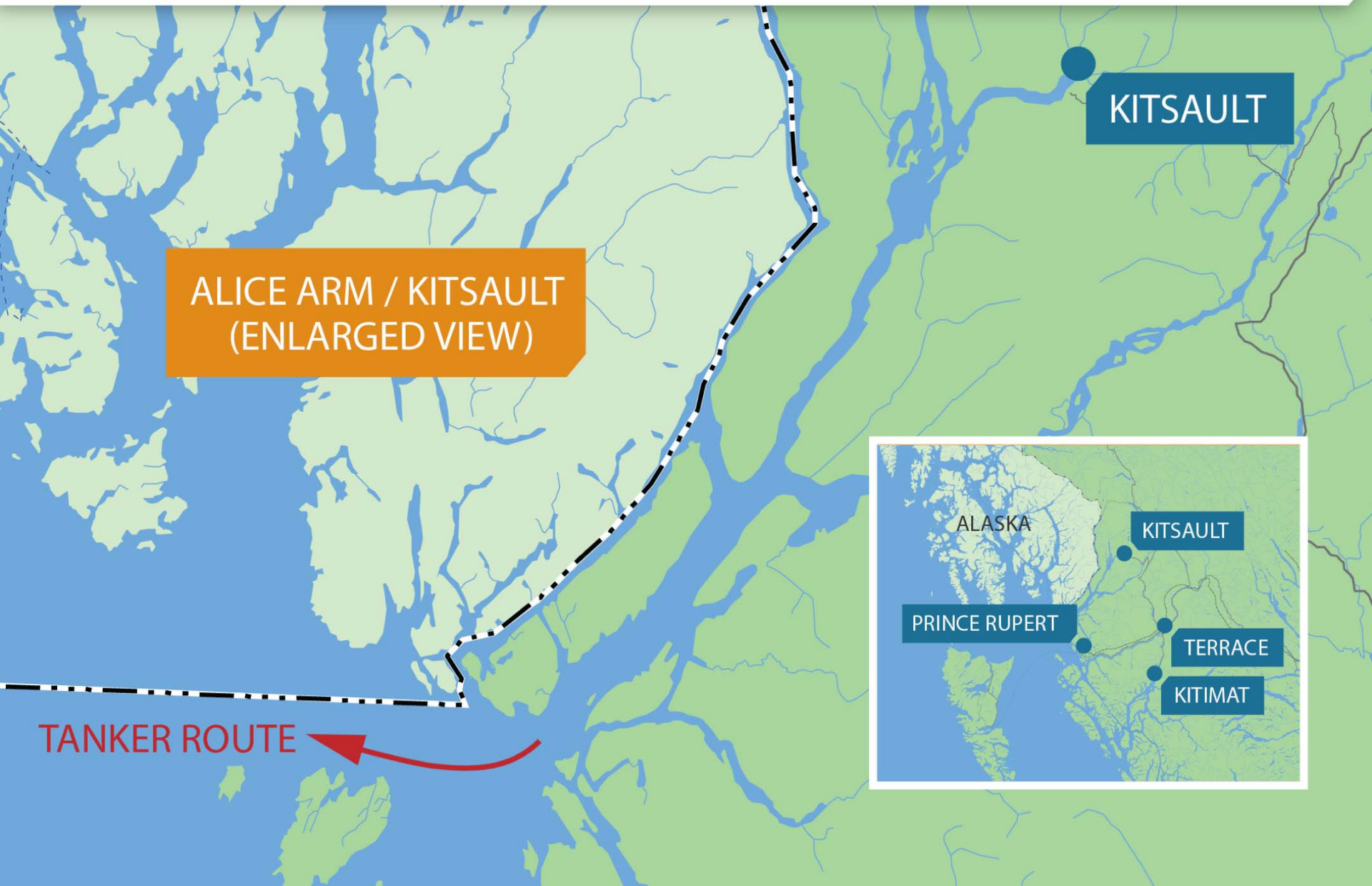



WWW.KITSAULTENERGY.COM

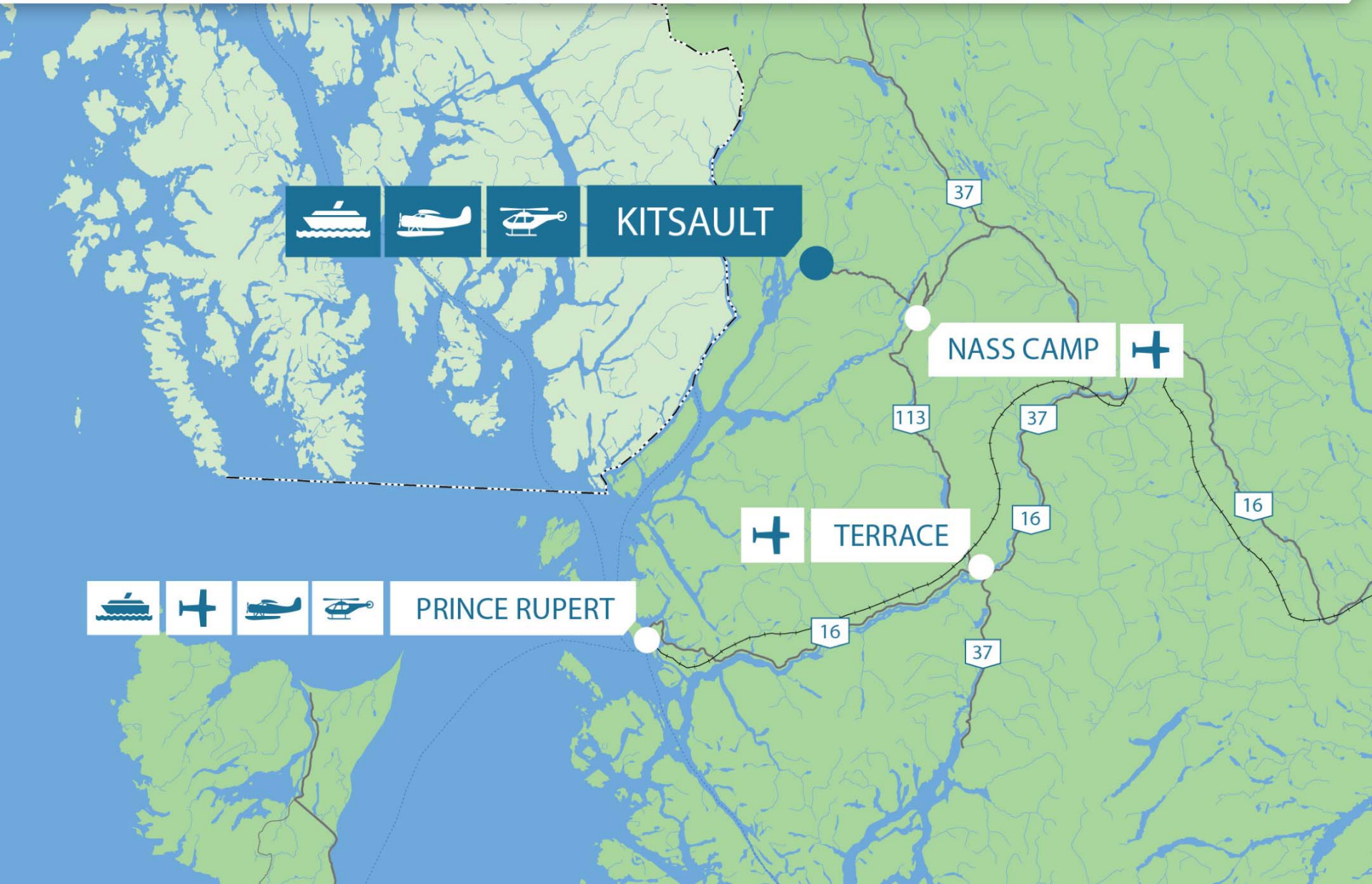



EXISTING HOUSING INFRASTRUCTURE:

SINGLE FAMILY HOMES

- 95 THREE BEDROOM HOMES AVAILABLE.

APARTMENT BUILDINGS

- 150 TWO AND THREE BEDROOM APARTMENTS AVAILABLE.

FUTURE DEVELOPMENT

- 30 BUILDING FOUNDATIONS ALREADY IN PLACE.
- VACANT LAND THE POTENTIAL DEVELOPMENT OF PRIME OCEAN AND MOUNTAIN VIEW LOTS.





COMMUNITY INFRASTRUCTURE:

RECREATION CENTRES

- THE 25,000 SQUARE FOOT COMMUNITY CENTRE.
- FOUR SHEET CURLING RINK, MOVIE THEATRE AND A PUB.

SHOPPING CENTRE

- 22,000 SQUARE FOOT SHOPPING CENTRE WITH A GROCERY STORE, BANK, AND POST OFFICE

EXECUTIVE HOUSE

- VIP GUEST HOUSE WITH 4 BEDROOMS, 5 BATHROOMS AND A BOARDROOM.

MEDICAL CENTRE

FIRE HALL

INDUSTRIAL BUILDINGS





WWW.KITSAULTENERGY.COM

 **KITSAULT
ENERGY**
FUELING THE FUTURE



KITSAULT, BC



WWW.KITSAULTENERGY.COM



KITSAULT, BC



WWW.KITSAULTENERGY.COM



KITSAULT, BC



WWW.KITSAULTENERGY.COM



KITSAULT, BC